

东莞市人民政府征收土地预公告

〔2024〕第1号

为实施塘厦镇石潭埔社区科技产业新城（一期）产城融合类更新单元中的二期、三期、四期“三旧”改造项目；东莞市塘厦镇石潭埔股份经济联合社、东莞市塘厦镇石潭埔第一股份经济合作社、东莞市塘厦镇石潭埔第二股份经济合作社、东莞市塘厦镇石潭埔第六股份经济合作社、东莞市塘厦镇石潭埔第七股份经济合作社申请将位于东深二路东侧石潭埔工业园的35.7287公顷集体土地转为国有建设用地；同时东莞市塘厦镇石潭埔股份经济联合社、东莞市塘厦镇石潭埔第一股份经济合作社、东莞市塘厦镇石潭埔第六股份经济合作社、东莞市塘厦镇石潭埔第七股份经济合作社申请将该项目涉及“三地”总面积0.3201公顷，办理征收手续0.2973公顷，保留集体建设用地面积0.0228公顷。根据《中华人民共和国土地管理法》第二条、第四十七条，《中华人民共和国土地管理法实施条例》第二十六条的规定，现将拟征收土地情况预公告如下：

一、拟征收土地的面积、位置和范围：集体建设用地转为国有建设用地面积35.7287公顷；“三地”办理征收面积0.2973公顷，位于石潭埔工业园区（详见附图）。

二、拟征收土地现状：转为国有建设用地涉及东莞市塘厦镇石潭埔股份经济联合社的集体土地6.9449公顷，东莞市塘厦镇石潭埔第一股份经济合作社的集体土地1.6988公顷，东莞市塘厦镇石潭埔第二股份经济合作社的集体土地2.5837公顷，东莞市塘厦镇石潭埔第六股份经济合作社的集体土地20.8549公顷，东莞市塘厦镇石潭埔第七股份经济合作社的集体土地3.6464公顷，合计35.7287公顷，全部为建设用地；“三地”范围涉及东莞市塘厦镇石潭埔股份经济联合社的集体土地0.0358公顷，东莞市塘厦镇石潭埔第一股份经济合作社的集体土地0.0148公顷，东莞市塘厦镇石潭埔第六股份经济合作社的集体土地0.1943公顷，东莞市塘厦镇石潭埔第七股份经济合作社的集体土地0.0524公顷，合计0.2973公顷，建设用地面积0.2727公顷，农用地面积0.0474公顷。

三、补偿安置方式：根据已签订的拆迁补偿安置协议，采取物业置换和货币补偿相结合模式，依据权籍调查确认的土地面积或建筑面积对土地和地上房屋整体核算，选择物业置换或货币补偿。对于地上临时性建筑物、搬迁费、临时安置费、办证费等采取货币补偿。

四、自本预公告已发布之日起，除正常生产生活外，任何单位和个人在拟征土地上抢建、加建的建（构）筑物，征收土地时一律不予补偿。

本公告期限为自公告张贴之日起不少于30日。

特此公告。

附件：1、拟征收土地用地界址红线图



塘厦镇石潭埔社区科技产业新城（一期）产城融合类更新单元（二、三、四期）更新改造地块

2522.78-38511.35

"三地"地块1界址点坐标		
点号	坐 标	坐 标
	X (m)	Y (m)
J1	2523810.812	38512377.239
J2	2523821.66	38512368.333
J3	2523780.151	38512384.091

"三地"地块2界址点坐标		
点号	坐 标	坐 标
	X (m)	Y (m)
J1	2523869.271	38512478.437
J2	2523588.414	38512237.101
J3	2523586.251	38512238.154
J4	2523566.985	38512179.194

"三地"地块4界址点坐标		
点号	坐 标	坐 标
	X (m)	Y (m)
J1	2523326.716	38512425.736
J2	2523347.531	38512490.631
J3	2523354.645	38512500.15
J4	2523355.028	38512501.109
J5	2523357.521	38512507.341
J6	2523358.952	38512522.724
J7	2523443.801	38512506.513
J8	2523336.843	38512505.472
J9	2523313.218	38512432.868
J10	2523306.098	38512435.219
J11	2523304.104	38512431.75

"三地"地块3界址点坐标		
点号	坐 标	坐 标
	X (m)	Y (m)
J1	2523685.387	38512416.733
J2	2523684.253	38512419.001
J3	2523685.497	38512420.026
J4	2523658.917	38512430.117
J5	2523657.243	38512430.688
J6	2523655.534	38512431.144
J7	2523652.57	38512431.779
J8	2523650.114	38512432.304
J9	2523649.461	38512431.6
J10	2523648.428	38512428.44
J11	2523649.548	38512428.247
J12	2523664.959	38512421.205
J13	2523680.962	38512413.893

"三地"地块5界址点坐标		
点号	坐 标	坐 标
	X (m)	Y (m)
J1	2523269.168	38512381.248
J2	2523276.812	38512403.043
J3	2523277.987	38512406.393
J4	2523277.974	38512406.389
J5	2523275.992	38512405.865
J6	2523271.84	38512393.252
J7	2523252.538	38512499.667
J8	2523244.938	38512397.658
J9	2523239.194	38512396.14
J10	2523235.155	38512397.319
J11	2523213.859	38512403.43
J12	2523197.886	38512408.773
J13	2523196.02	38512403.191
J14	2523203.406	38512401.276
J15	2523251.162	38512386.369
J16	2523251.293	38512386.714
J17	2523264.154	38512382.781

"三地"地块6界址点坐标		
点号	坐 标	坐 标
	X (m)	Y (m)
J1	2523194.11	38512403.699
J2	2523188.972	38512405.387
J3	2523172.235	38512403.32
J4	2523170.656	38512403.124
J5	2523170.768	38512402.993
J6	2523170.796	38512402.992
J7	2523176.519	38512402.88

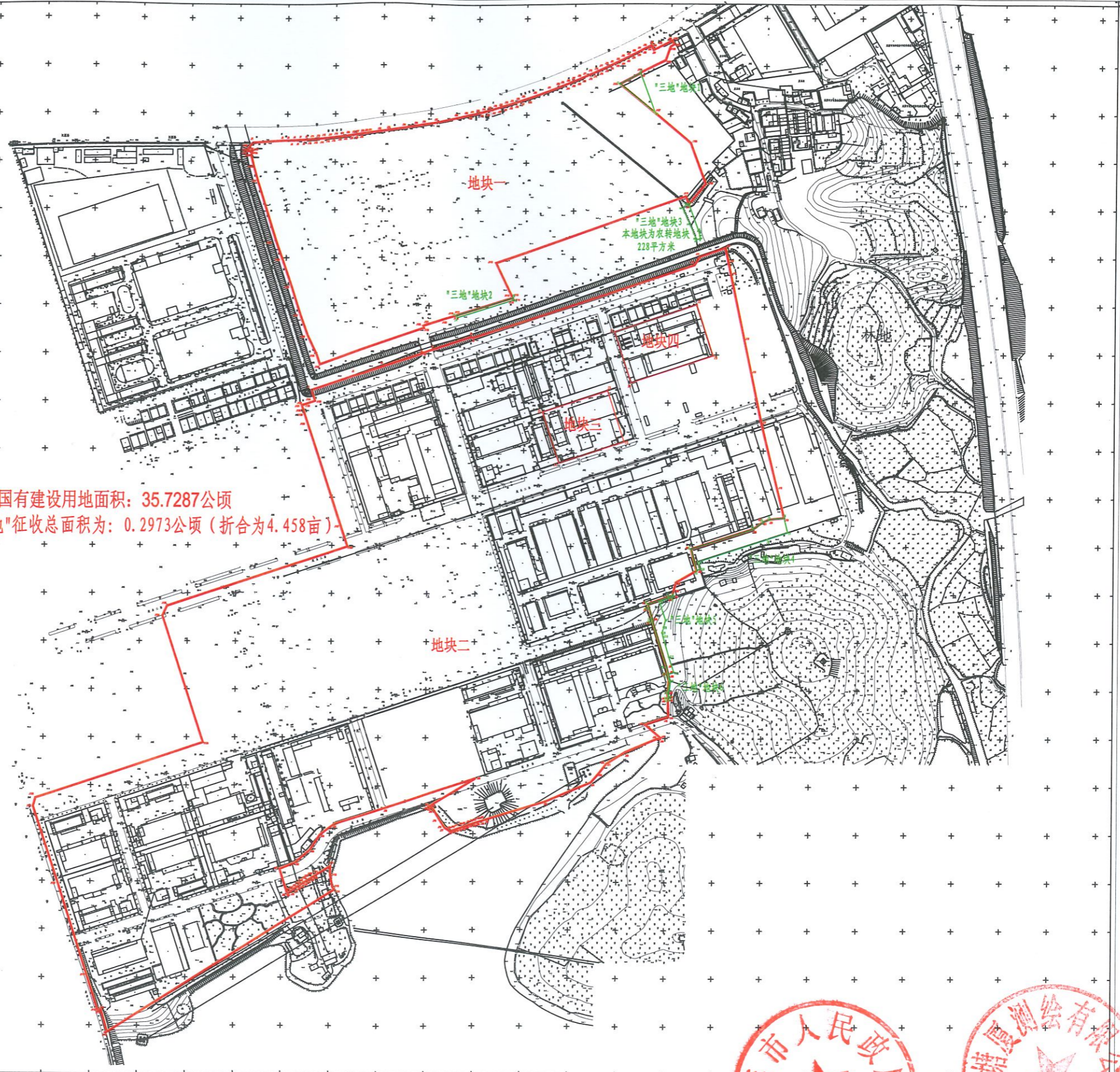

转为国有建设用地面积: 35.7287公顷
 "三地"征收总面积为: 0.2973公顷 (折合为4.458亩)

东莞市塘厦测绘有限公司

2000国家大地坐标系。
 1985国家高程基准，等高距为0.5米。
 GB/T 20257.1-2017 国家基本比例尺地图图式第1部分
 1: 500 1: 1000 1: 2000地形图图式
 2024年6月数字化测图。

1: 500



地块一界址点坐标 (1)			地块一界址点坐标 (2)		
点号	坐 标		点号	坐 标	
	X (m)	Y (m)		X (m)	Y (m)
J1	2523748.792	38511964.016	J71	2523818.825	38512311.785
J2	2523751.033	38511995.248	J72	2523820.034	38512314.659
J3	2523751.302	38512001.516	J73	2523821.255	38512317.527
J4	2523751.452	38512004.649	J74	2523822.485	38512320.392
J5	2523751.611	38512007.782	J75	2523823.726	38512323.252
J6	2523751.781	38512010.915	J76	2523824.977	38512326.107
J7	2523751.960	38512014.046	J77	2523826.238	38512328.958
J8	2523752.149	38512017.178	J78	2523827.510	38512331.805
J9	2523752.348	38512020.308	J79	2523828.792	38512334.647
J10	2523752.556	38512023.438	J80	2523830.084	38512337.484
J11	2523752.775	38512026.568	J81	2523831.386	38512340.317
J12	2523753.003	38512029.696	J82	2523832.698	38512343.145
J13	2523753.241	38512032.824	J83	2523834.021	38512345.968
J14	2523753.489	38512035.951	J84	2523835.353	38512348.786
J15	2523753.746	38512039.078	J85	2523836.696	38512351.600
J16	2523754.014	38512042.203	J86	2523838.049	38512354.408
J17	2523754.291	38512045.328	J87	2523839.412	38512357.212
J18	2523754.578	38512048.452	J88	2523840.785	38512360.011
J19	2523754.875	38512051.575	J89	2523842.168	38512362.805
J20	2523755.182	38512054.697	J90	2523843.561	38512365.594
J21	2523755.494	38512057.781	J91	2523844.964	38512368.378
J22	2523755.824	38512060.937	J92	2523846.377	38512371.157
J23	2523756.160	38512064.056	J93	2523847.800	38512373.931
J24	2523756.506	38512067.174	J94	2523849.233	38512376.700
J25	2523756.862	38512070.291	J95	2523850.676	38512379.463
J26	2523757.064	38512072.011	J96	2523848.590	38512380.487
J27	2523757.227	38512073.406	J97	2523845.676	38512381.918
J28	2523757.731	38512077.595	J98	2523849.791	38512389.893
J29	2523757.801	38512078.466	J99	2523855.442	38512400.845
J30	2523758.382	38512082.746	J100	2523855.442	38512401.253
J31	2523758.923	38512086.911	J101	2523851.665	38512403.201
J32	2523760.152	38512096.686	J102	2523849.297	38512399.292
J33	2523761.427	38512106.119	J103	2523835.061	38512394.391
J34	2523764.009	38512122.416	J104	2523822.051	38512368.184
J35	2523766.033	38512135.060	J105	2523821.660	38512368.333
J36	2523767.558	38512143.370	J106	2523810.812	38512347.239
J37	2523769.900	38512156.136	J107	2523780.151	38512384.091
J38	2523774.925	38512177.459	J108	2523748.932	38512421.614
J39	2523777.838	38512188.701	J109	2523706.815	38512437.604
J40	2523778.309	38512190.660	J110	2523685.497	38512420.026
J41	2523779.052	38512193.708	J111	2523693.509	38512416.985
J42	2523780.635	38512199.739	J112	2523624.600	38512219.515
J43	2523781.442	38512202.750	J113	2523588.419	38512237.116
J44	2523782.261	38512205.758	J114	2523586.256	38512238.169
J45	2523783.090	38512208.763	J115	2523586.251	38512238.154
J46	2523783.930	38512211.766	J116	2523588.414	38512237.101
J47	2523784.781	38512214.765	J117	2523569.271	38512178.437
J48	2523785.642	38512217.761	J118	2523569.279	38512178.434
J49	2523786.514	38512220.754	J119	2523568.620	38512176.414
J50	2523787.397	38512223.744	J120	2523565.203	38512165.942
J51	2523788.291	38512226.731	J121	2523558.920	38512146.688
J52	2523789.196	38512229.714	J122	2523558.111	38512144.210
J53	2523790.111	38512232.695	J123	2523555.803	38512144.974
J54	2523791.037	38512235.672	J124	2523517.943	38512036.050
J55	2523791.973	38512238.645	J125	2523527.965	38512032.708
J56	2523792.920	38512241.615	J126	2523548.221	38512023.250
J57	2523793.878	38512244.582	J127	2523569.939	38512015.464
J58	2523794.847	38512247.545	J128	2523599.426	38512005.937
J59	2523796.118	38512251.387	J129	2523627.750	38511996.239
J60	2523798.890	38512260.039	J130	2523645.321	38511989.917
J61	2523804.142	38512274.849	J131	2523709.216	38511969.677
J62	2523807.782	38512284.121	J132	2523724.137	38511965.402
J63	2523809.519	38512288.647	J133	2523736.628	38511962.293
J64	2523810.645	38512291.554	J134	2523739.764	38511963.480
J65	2523811.783	38512294.456	J135	2523740.043	38511963.650
J66	2523812.930	38512297.355	J136	2523740.004	38511960.981
J67	2523814.088	38512300.249	J137	2523739.971	38511958.654
J68	2523815.257	38512303.140	J138	2523740.014	38511958.657
J69	2523816.436	38512306.026	J139	2523744.021	38511959.986
J70	2523817.625	38512308.908			

地块二界址点坐标					
点号	坐 标		点号	坐 标	
	X (m)	Y (m)		X (m)	Y (m)
J1	2523491.184	38512027.807	J69	2523035.926	38512188.054
J2	2523505.838	38512072.493	J70	2523035.274	38512186.162
J3	2523508.515	38512081.528	J71	2523034.615	38512184.272
J4	2523515.568	38512102.163	J72	2523033.950	38512182.384
J5	2523529.357	38512144.211	J73	2523033.279	38512180.499
J6	2523530.009	38512144.417	J74	2523032.601	38512178.615
J7	2523533.481	38512154.574	J75	2523031.803	38512176.422
J8	2523547.044	38512194.259	J76	2523032.089	38512175.875
J9	2523546.102	38512195.555	J77	2523035.220	38512171.140
J10	2523622.065	38512426.881	J78	2523037.069	38512169.617
J11	2523630.631	38512431.802	J79	2523044.222	38512164.989
J12	2523640.345	38512458.938	J80	2523054.877	38512158.901
J13	2523625.301	38512462.156	J81	2523056.199	38512156.478
J14	2523612.446	38512464.907	J82	2523056.313	38512156.543
J15	2523545.444	38512479.243	J83	2523056.346	38512156.207
J16	2523510.830	38512486.650	J84	2523057.546	38512154.008
J17	2523458.105	38512497.931	J85	2523086.731	38512202.085
J18	2523389.886	38512514.989	J86	2523056.374	38512107.707
J19	2523358.952	38512522.724	J87	2523039.058	38512054.751
J20	2523357.521	38512537.341	J88	2523027.882	38512039.949
J21	2523355.028	38512501.109	J89	2523011.796	38512029.480
J22	2523354.645	38512500.150	J90	2522998.646	38512014.153
J23	2523347.531	38512490.631	J91	2522992.251	38511998.333
J24	2523326.716	38512425.736	J92	2522966.466	38512006.416
J25	2523304.104	38512431.750	J93	2522966.890	38512007.011
J26	2523299.367	38512423.508	J94	2522968.049	38512008.652
J27	2523291.611	38512410.014	J95	2522969.200	38512010.298
J28	2523283.801	38512407.950	J96	2522970.345	38512011.949
J29	2523277.987	38512406.393	J97	2522971.482	38512013.604
J30	2523276.812	38512403.043	J98	2522972.613	38512015.265
J31	2523269.168	38512403.248	J99	2522973.737	38512016.930
J32	2523264.154	38512382.781	J100	2522974.854	38512018.599
J33	2523251.293	38512386.714	J101	2522975.964	38512020.274
J34	2523251.162	38512386.369	J102	2522977.066	38512021.953
J35	2523203.406	38512401.276	J103	2522978.162	38512023.636
J36	2523196.020	38512403.191	J104	2522979.251	38512025.324
J37	2523195.967	38512403.032	J105	2522980.333	38512027.017
J38	2523194.110	38512403.699	J106	2522981.407	38512028.714
J39	2523176.519	38512402.880	J107	2522982.475	38512030.416
J40	2523170.768	38512402.993	J108	2522983.535	38512032.122
J41	2523170.669	38512403.109	J109	2522984.588	38512033.833
J42	2523170.656	38512403.124	J110	2522985.634	38512035.548
J43	2523169.756	38512403.012	J111	2522995.100	38512051.140
J44	2523151.485	38512403.369	J112	2522985.453	38512051.140
J45	2523150.551	38512400.465	J113	2522973.275	38512053.677
J46	2523143.721	38512379.231	J114	2522970.760	38512055.354
J47	2523129.677	38512395.596	J115	2522822.256	38511818.902
J48	2523128.605	38512395.091	J116	2522845.186	38511812.350
J49	2523128.605	38512391.637	J117	2522844.401	38511809.941
J50	2523114.639	38512358.333	J118	2522844.102	38511809.022
J51	2523103.022	38512339.882	J119	2522881.861	38511796.934
J52	2523102.463	38512338.995	J120	2522977.530	38511766.306
J53	2523091.720	38512330.759	J121	2523056.974	38511739.962
J54	2523082.696	38512322.796	J122	2523065.668	38511742.351
J55	2523062.730	38512275.638	J123	2523123.624	38511917.440
J56	2523043.804	38512212.848	J124	2523255.776	38511873.929
J57	2523043.238	38512210.928	J125	2523265.716	38511878.539
J58	2523042.665	38512209.011	J126	2523327.988	38512066.665
J59	2523042.085	38512207.095	J127	2523349.810	38512059.421
J60	2523041.498	38512205.182	J128	2523456.732	38512023.925
J61	2523040.906	38512203.270	J129	2523465.799	38512020.917
J62	2523040.306	38512201.361	J130	2523470.495	38512019.359
J63	2523039.700	38512199.453	J131	2523475.266	38512017.776
J64	2523039.087	38512197.548	J132	2523475.560	38512018.671
J65	2523038.468	38512195.645	J133	2523477.065	38512023.264
J66	2523037.842	38512193.744	J134	2523477.827	38512025.586
J67	2523037.210	38512191.845	J135	2523479.746	38512031.439
J68	2523036.571	38512189.948	J136	2523488.609	38512028.625

地块三界址点坐标		
点号	坐 标	
	X (m)	Y (m)
J1	2523469.27	38512269.511
J2	2523491.552	38512337.375
J3	2523438.347	38512354.844
J4	252	