

东莞市人民政府征收土地补偿安置方案公告

东府征补告（6）〔2020〕第2号

为实现土地集约利用，保证东莞至番禺高速公路桥头至沙田段项目开发，提高区域土地利用效益，东莞市人民政府拟征收东莞市厚街镇白濠股份经济联合社、宝塘股份经济联合社、大迳股份经济联合社、厚街镇经济联合总社、下汴股份经济联合社、新围股份经济联合社、涌口股份经济联合社的集体土地 80.2909 公顷。具体征地范围以征地地形图红线圈定和坐标标定的位置为准（见征地范围红线图）。根据《中华人民共和国土地管理法》第 47 条规定，现拟定了《征收土地补偿安置方案》，并将有关内容和事项公告如下：

一、土地补偿安置标准（万元/公顷）

被征地农村集体经济组织	耕地	园地	林地	养殖水面	其他农用地 (不含养殖水面)	建设用地	未利用地
厚街镇白濠股份经济联合社	175	135	62	/	181	200	55
厚街镇宝塘股份经济联合社	/	135	62	/	181	/	/
厚街镇大迳股份经济联合社	/	135	/	/	181	/	/
厚街镇经济联合总社	/	/	62	/	181	200	55
厚街镇下汴股份经济联合社	175	135	62	/	181	200	55
厚街镇新围股份经济联合社	175	135	/	/	181	200	55
厚街镇涌口股份经济联合社	/	/	62	/	181	/	/

二、被征地农村集体经济组织征地面积及补偿安置费用

被征地农村集体经济组织	总面积 (公顷)	耕地 (公顷)	园地 (公顷)	林地 (公顷)	养殖 水面 (公顷)	其他农用地 (不含养殖 水面)(公顷)	建设用地 (公顷)	未利用地 (公顷)	青苗补偿 费 (万元)	地上附作物 补偿费 (万元)	征地总费用 (万元)
厚街镇白濠股份经济联合社	15.5496	1.4340	1.9669	2.7114	0.0000	0.6493	6.3983	2.3897	142.8000	7012.3900	60343.8559
厚街镇宝塘股份经济联合社	0.2892	0.0000	0.0974	0.0284	0.0000	0.1634	0.0000	0.0000	0.0000	0.0000	
厚街镇大迳股份经济联合社	5.9840	0.0000	5.7939	0.0000	0.0000	0.1901	0.0000	0.0000	357.0400	0.0000	
厚街镇经济联合总社	0.1176	0.0000	0.0000	0.0174	0.0000	0.0152	0.0030	0.0820	0.0000	0.0000	
厚街镇下汴股份经济联合社	23.1691	1.2685	6.8873	5.8046	0.0000	1.1887	5.7317	2.2883	108.2000	39605.5000	
厚街镇新围股份经济联合社	32.6551	3.1753	25.0008	0.0000	0.0000	1.8073	0.0049	2.6668	736.3500	1686.5000	
厚街镇涌口股份经济联合社	2.5263	0.0000	0.0000	2.4905	0.0000	0.0358	0.0000	0.0000	46.4000	0.0000	
合计	80.2909	5.8778	39.7463	11.0523	0.0000	4.0498	12.1379	7.4268	1390.7900	48304.3900	

三、农业人员安置

发放货币安置。

四、留用地安置

留用地按实际征地面积的 10% 安排（即 8.0291 公顷），根据被征地村集体意愿折算成货币补偿，折算补偿标准为 323 万元/公顷，补偿总额为 2593.3993 万元。

五、社保安置

本次征收土地涉及应参加养老保险的被征地农民人数为 491 人。目前被征地农民个人最低缴费标准为每人每月 270.08 元，缴费年限为 15 年。按个人最低缴费标准缴纳 15 年的被征地农民养老保障资金为 48614.4 元。

六、 反映意见和申请听证期限

征地补偿安置方案公告征集意见期限为公告张贴之日起 30 日。拟征收土地的集体经济组织及其成员、使用权人或实际使用人对征地补偿安置方案有不同意见的，请于公告张贴之日起 30 日内提出；要求听证的，请于公告张贴之日起，至公告征集意见期限结束后 5 个工作日内，以书面形式向东莞市人民政府提出。

七、 补偿登记：拟征土地的所有权人、使用权人应当在本公告张贴之日起 30 日内，持不动产权属证明材料办理补偿登记。

八、 反映意见、提交听证申请和补偿登记地点：厚街镇珊美岳范山公园一环路二巷 1 号厚街自然资源分局

（联系人：黄嘉敏，联系电话：0769-85582711 转 611）

特此公告。

附件：征地范围红线图

公开方式：主动公开



东莞市莞番高速公路桥头至沙田段（厚街镇）用地红线图18-1

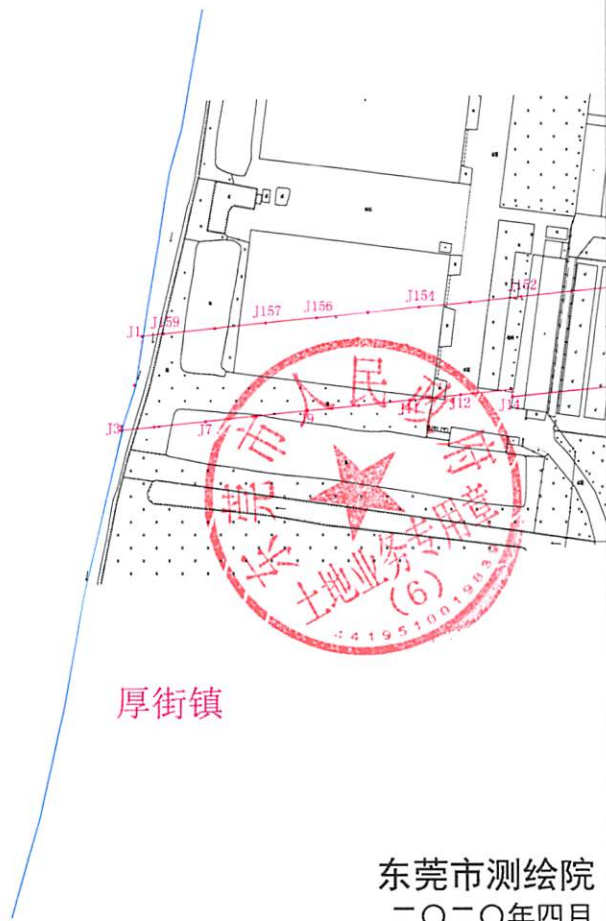
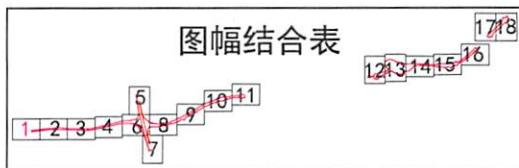

沙田镇

厚街镇

2000国家大地坐标系
1985国家高程基准

1:2000

东莞市测绘院
二〇二〇年四月

东莞市莞番高速公路桥头至沙田段（厚街镇）用地红线图18-2

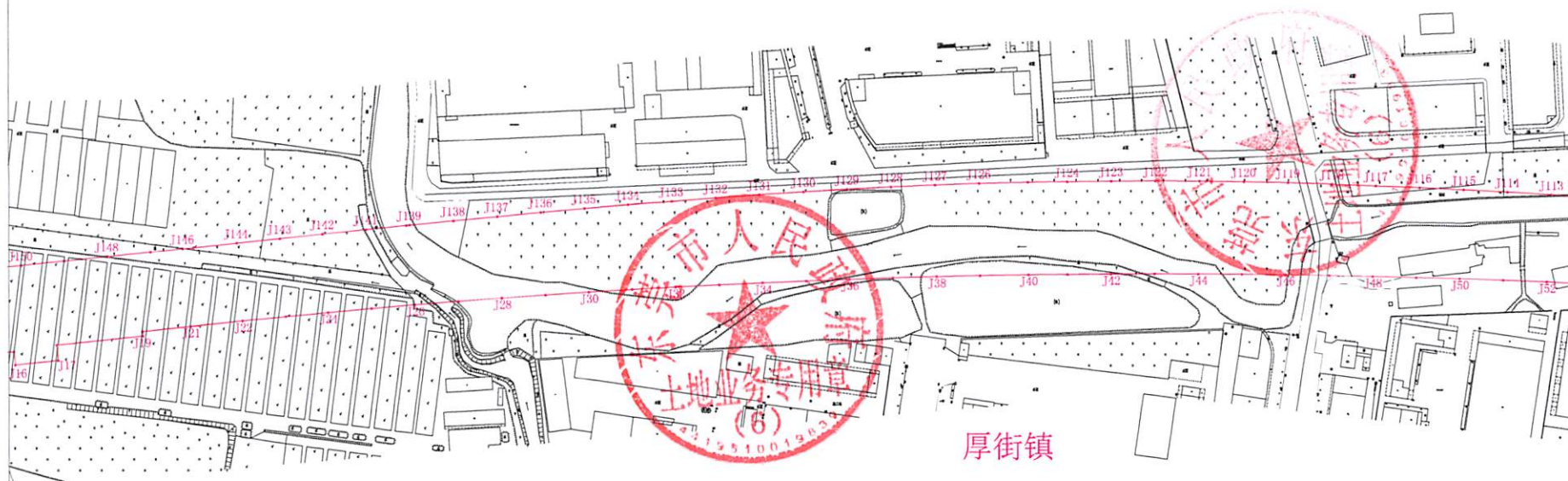
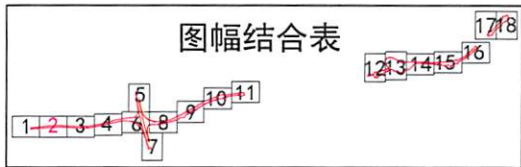

2000国家大地坐标系
1985国家高程基准

1:2000

东莞市测绘院
二〇二〇年四月

东莞市莞番高速公路桥头至沙田段（厚街镇）用地红线图18-3

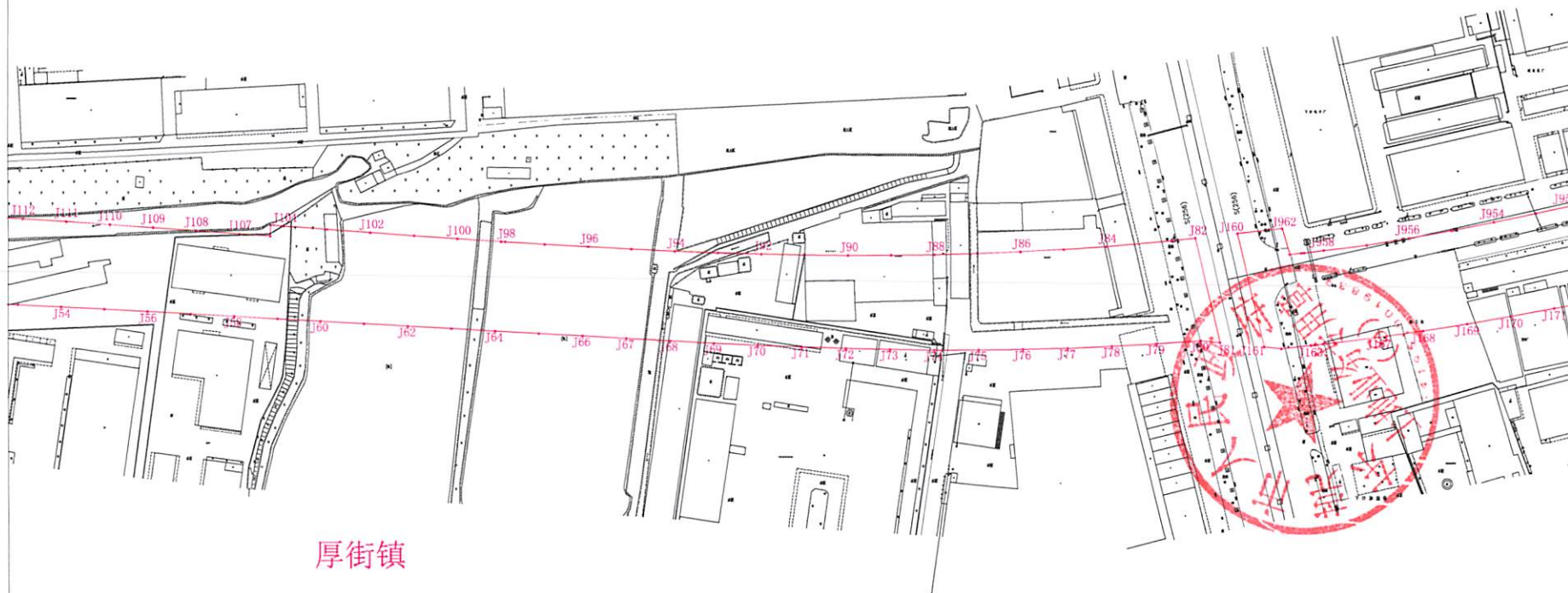
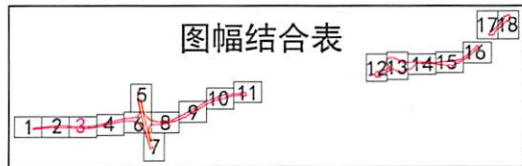

厚街镇

2000国家大地坐标系

1985国家高程基准

1:2000

东莞市测绘院
二〇二〇年四月

东莞市莞番高速公路桥头至沙田段（厚街镇）用地红线图18-4

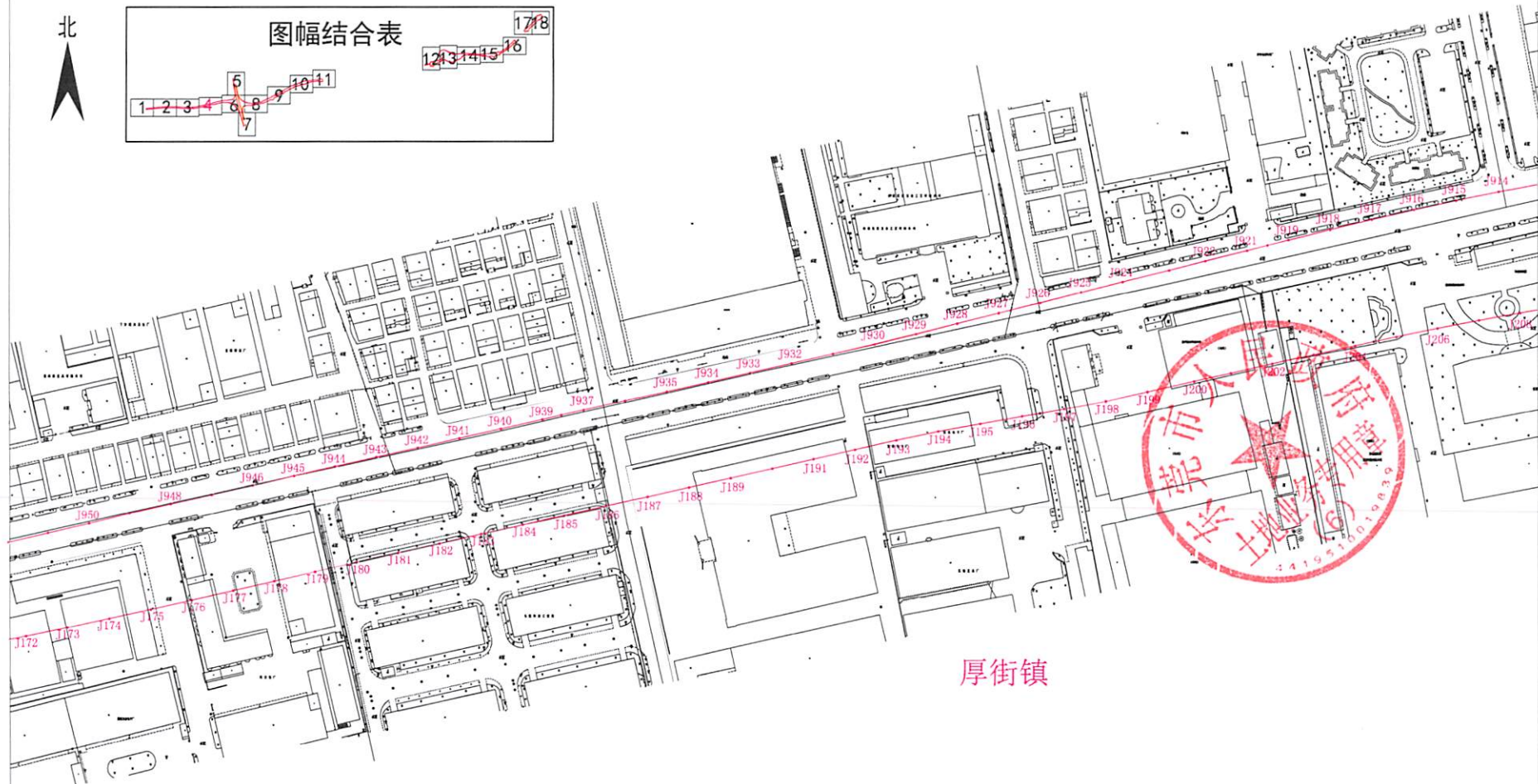
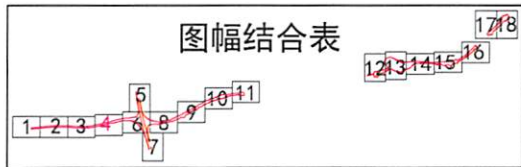

厚街镇

2000国家大地坐标系
1985国家高程基准

1:2000

东莞市测绘院
二〇二〇年四月

东莞市莞番高速公路桥头至沙田段（厚街镇）用地红线图18-5

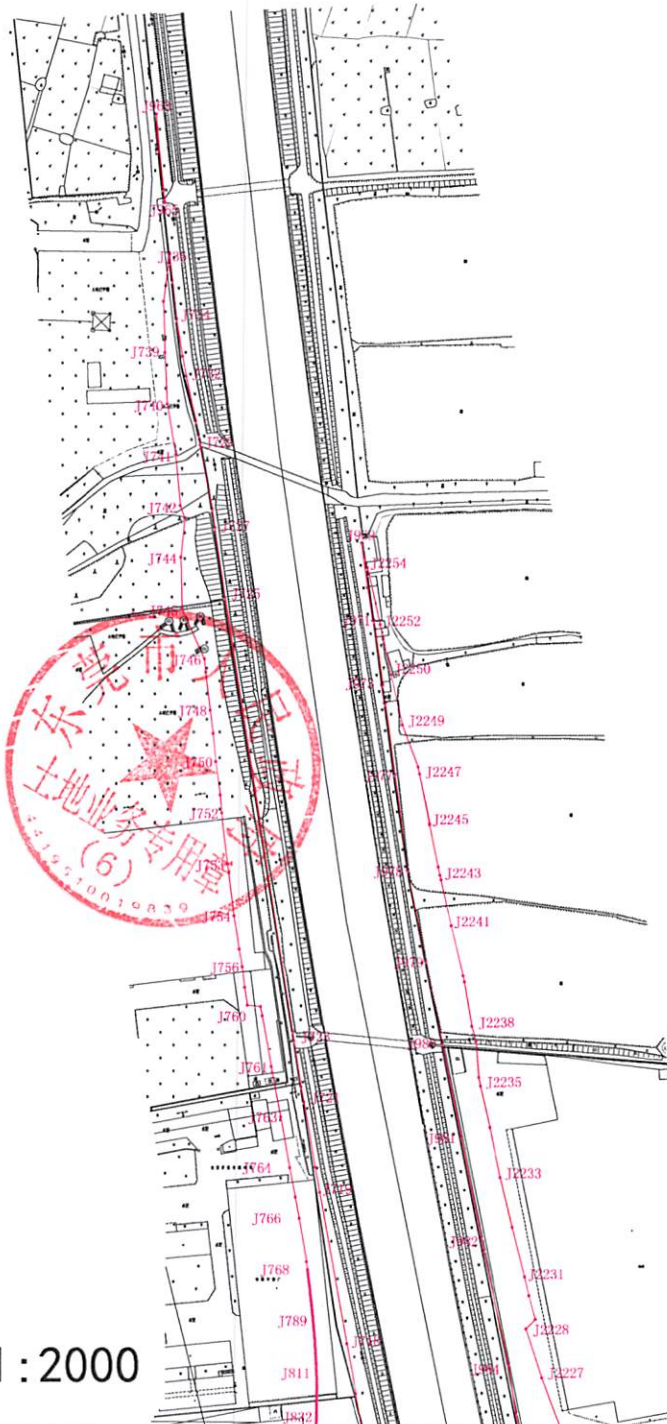
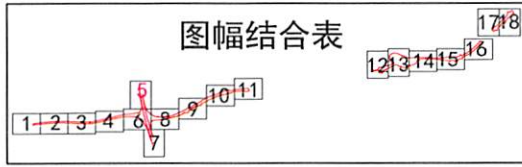

2000国家大地坐标系
1985国家高程基准

1:2000

东莞市测绘院
二〇二〇年四月

东莞市莞番高速公路桥头至沙田段（厚街镇）用地红线图18-8

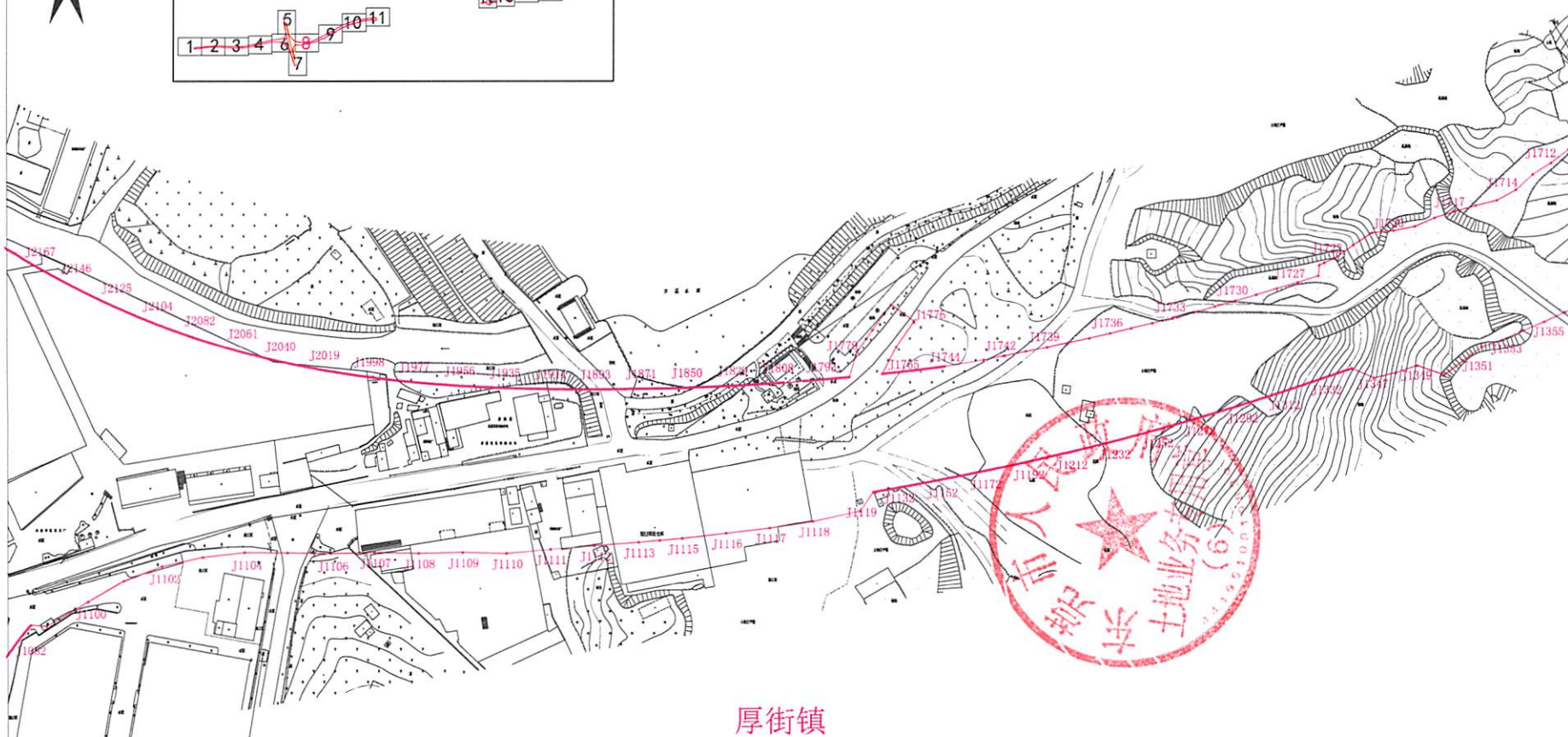
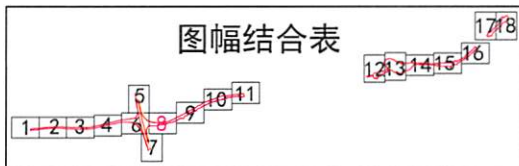

东莞市莞番高速公路桥头至沙田段（厚街镇）用地红线图18-11

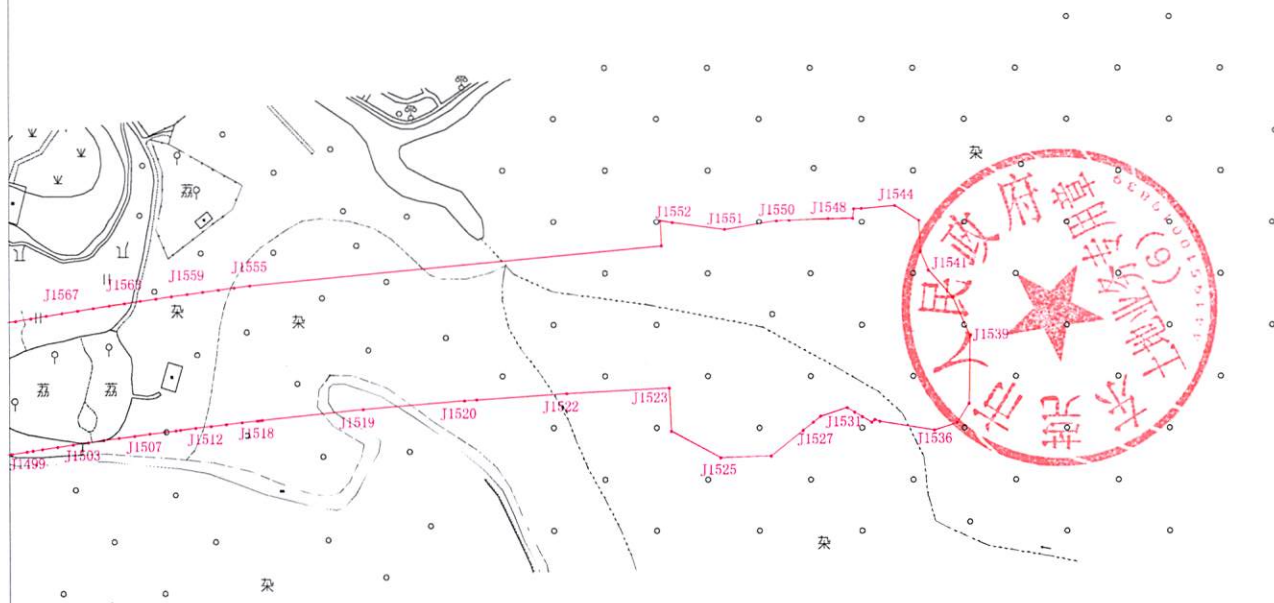
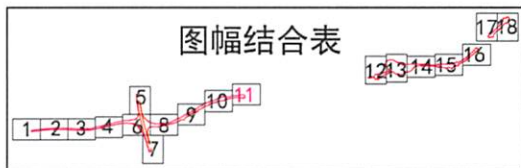

厚街镇

2000国家大地坐标系
1985国家高程基准

1:2000

东莞市测绘院
二〇二〇年四月

东莞市莞番高速公路桥头至沙田段（厚街镇）用地红线图18-12

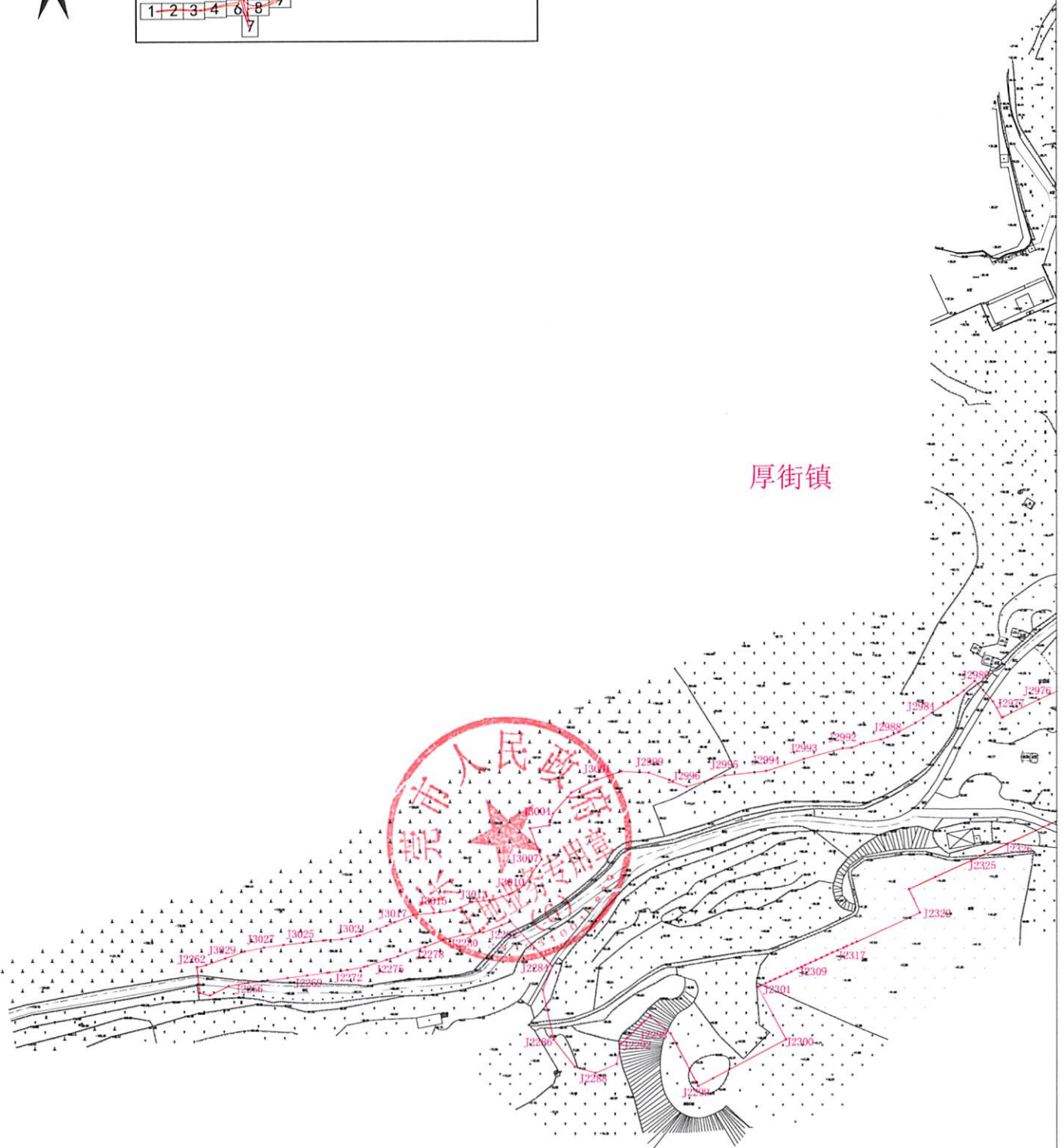
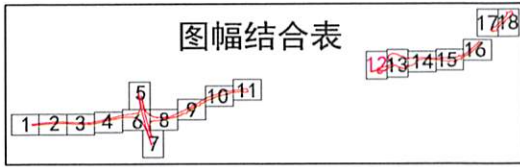

厚街镇

2000国家大地坐标系
1985国家高程基准

1:2000

东莞市测绘院
二〇二〇年四月

东莞市莞番高速公路桥头至沙田段（厚街镇）用地红线图18-13

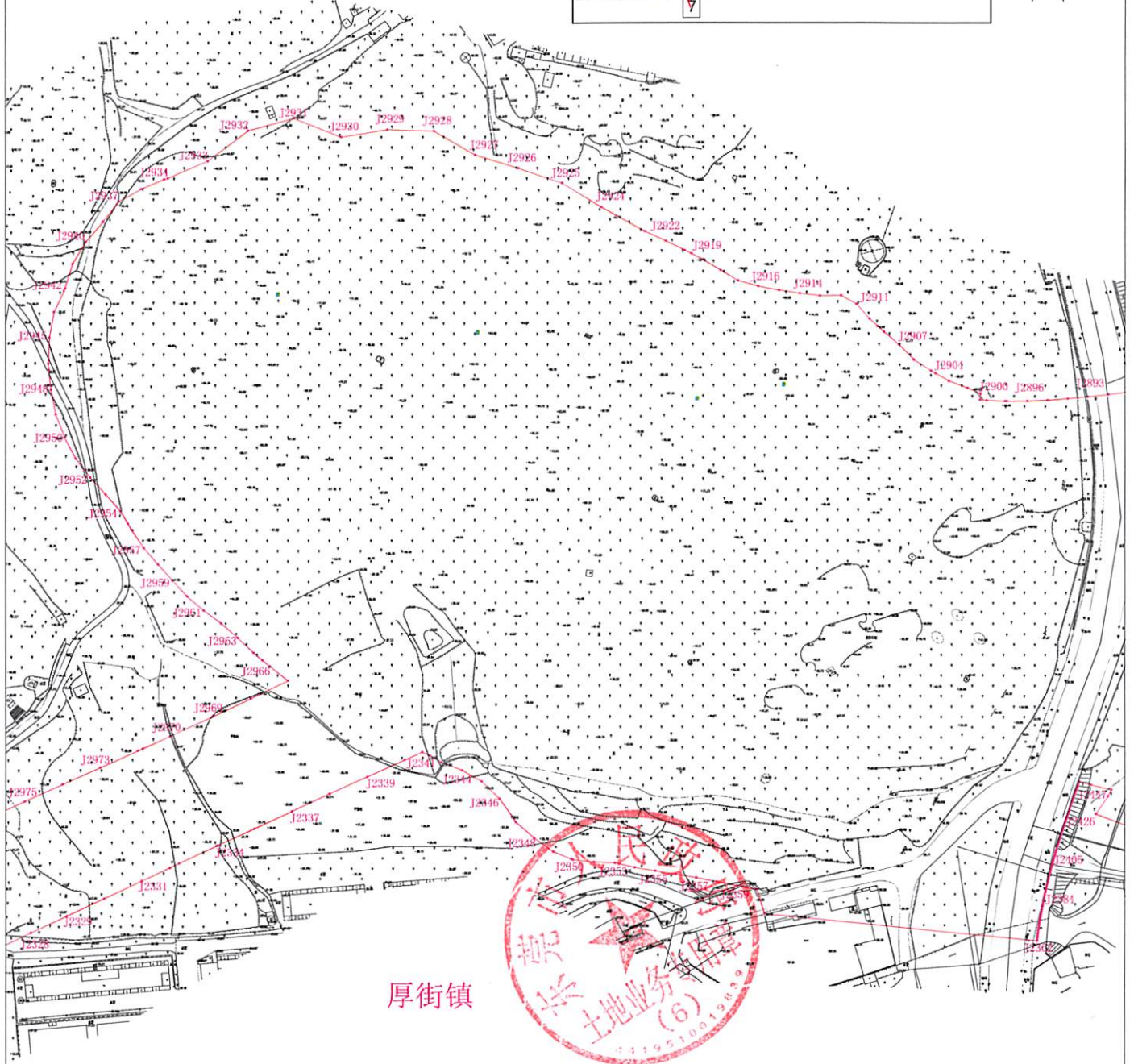
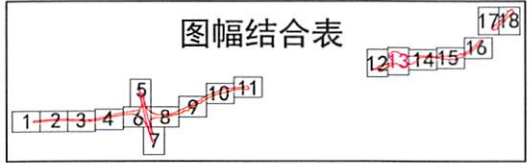

厚街镇

2000国家大地坐标系
1985国家高程基准

1:2000

东莞市测绘院
二〇二〇年四月

东莞市莞番高速公路桥头至沙田段（厚街镇）用地红线图18-14

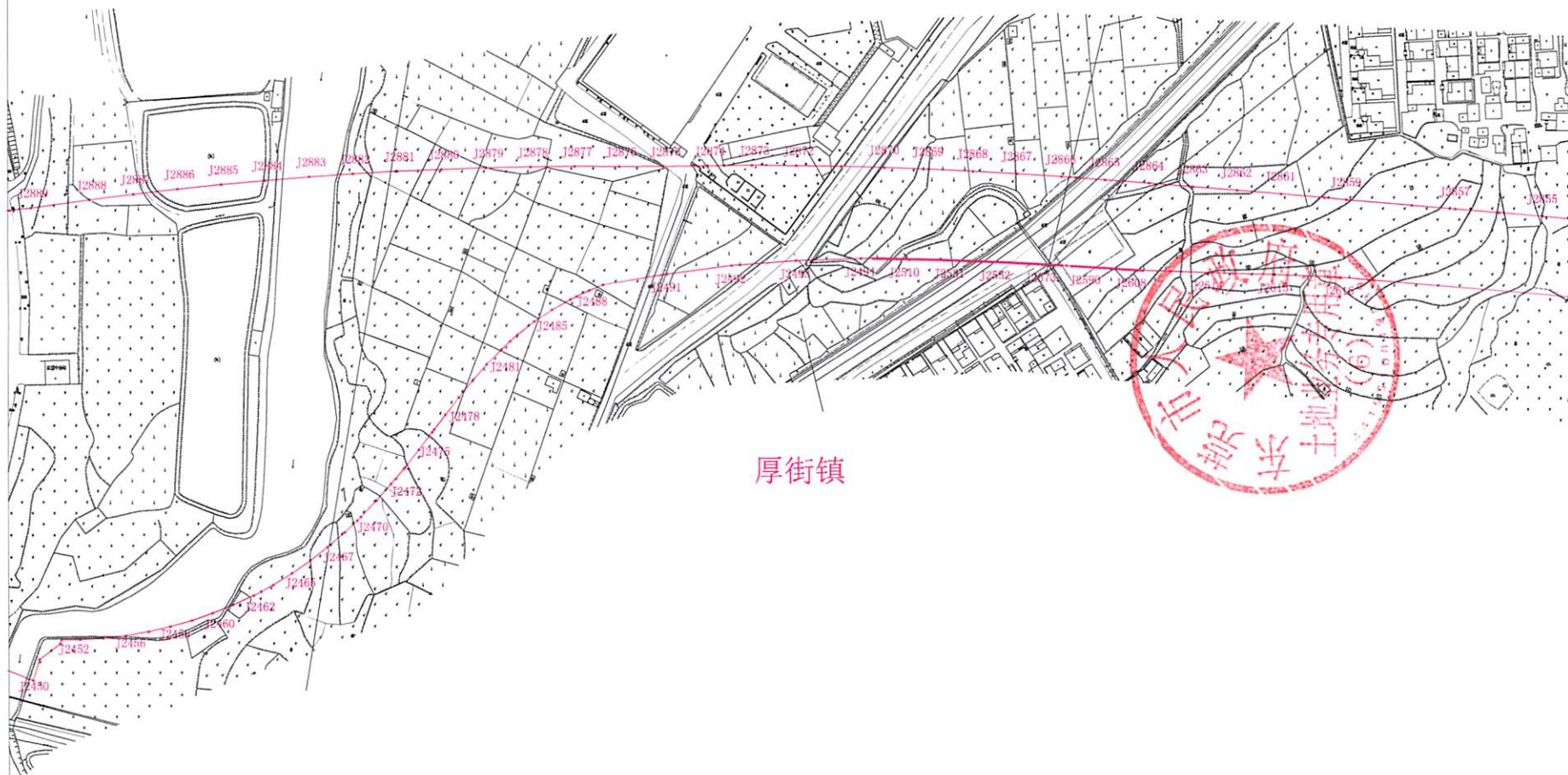
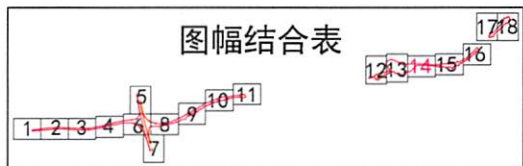

2000国家大地坐标系
1985国家高程基准

1:2000

东莞市测绘院
二〇二〇年四月

东莞市莞番高速公路桥头至沙田段（厚街镇）用地红线图18-15

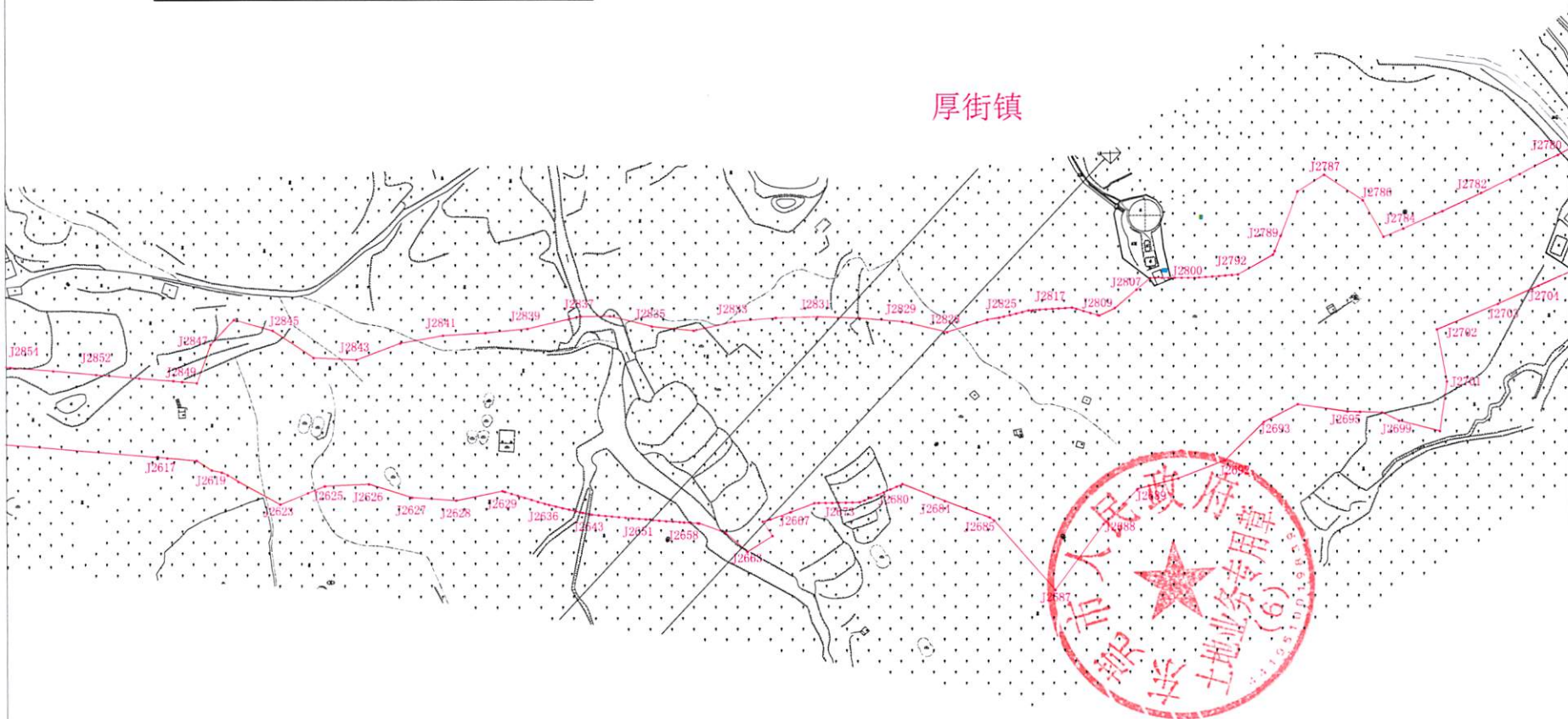
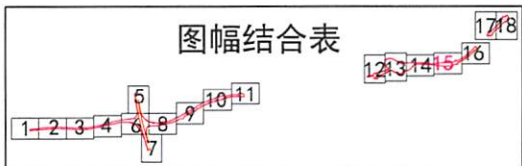

2000国家大地坐标系
1985国家高程基准

1:2000

东莞市测绘院
二〇二〇年四月

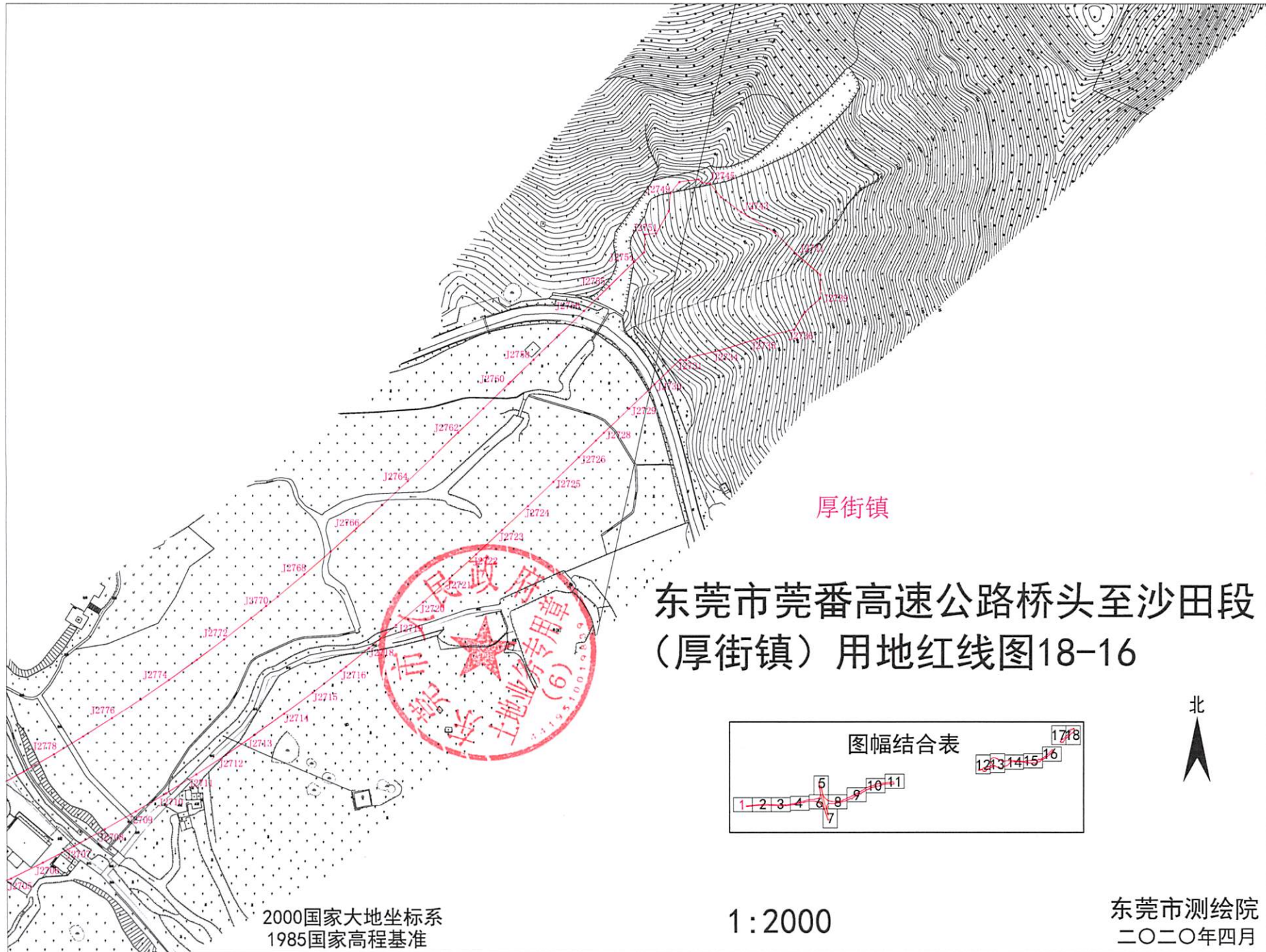

厚街镇

东莞市莞番高速公路桥头至沙田段 (厚街镇) 用地红线图18-16

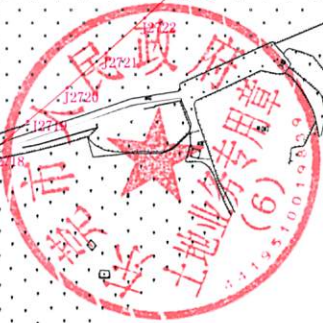

图幅结合表

1	2	3	4	5	6	7	8	9	10	11			
							12	13	14	15	16	17	18



2000国家大地坐标系
1985国家高程基准

1:2000

东莞市测绘院
二〇二〇年四月

东莞市莞番高速公路桥头至沙田段（厚街镇）用地红线图18-17

1:2000

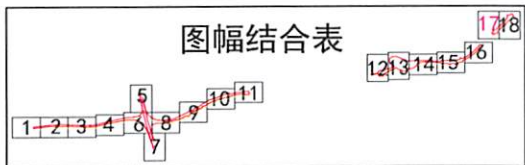

厚街镇



2000国家大地坐标系
1985国家高程基准

东莞市测绘院
二〇二〇年四月

界址点坐标		点号	坐标		点号	坐标		点号	坐标		点号	坐标		点号	坐标		点号	坐标		
			X(m)	Y(m)		X(m)	Y(m)		X(m)	Y(m)		X(m)	Y(m)		X(m)	Y(m)		X(m)	Y(m)	
		160	2531110.164	38464357.395	J123	2531164.335	38463999.005	J186	2531179.902	38465214.889	J249	2531283.431	38465850.807	J312	2531278.714	38465910.579	J375	2531271.992	38465973.417	
		161	2531109.014	38464377.361	J124	2531164.102	38463978.865	J187	2531184.302	38465234.399	J250	2531283.402	38465851.793	J313	2531277.724	38465916.885	J376	2531271.708	38465974.357	
		162	2531107.863	38464397.329	J125	2531163.756	38463960.845	J188	2531188.702	38465253.909	J251	2531283.372	38465852.779	J314	2531277.567	38465917.833	J377	2531271.421	38465975.293	
		163	2531106.713	38464417.295	J126	2531163.152	38463938.593	J189	2531193.102	38465273.419	J252	2531283.342	38465853.765	J315	2531277.407	38465918.781	J378	2531271.131	38465976.229	
J11	2531105.940	38463311.525	164	2531105.563	38464437.263	J127	2531162.436	38463918.463	J190	2531197.501	38465292.929	J253	2531283.311	38465854.751	J316	2531277.245	38465919.729	J379	2531270.838	38465977.165
J12	2531086.966	38463308.523	165	2531104.412	38464457.229	J128	2531161.558	38463898.341	J191	2531201.901	38465312.439	J254	2531283.278	38465855.737	J317	2531277.080	38465920.675	J380	2531270.541	38465978.099
J13	2531071.119	38463303.500	166	2531103.262	38464477.197	J129	2531160.524	38463878.233	J192	2531206.301	38465331.949	J255	2531283.245	38465856.723	J318	2531276.986	38465921.209	J381	2531270.242	38465979.031
J14	2531069.721	38463303.396	167	2531102.114	38464497.175	J130	2531159.343	38463858.143	J193	2531210.701	38465351.459	J256	2531283.211	38465857.707	J319	2531284.249	38465922.297	J382	2531269.940	38465979.963
J15	2531069.396	38463303.320	168	2531100.993	38464517.181	J131	2531158.027	38463838.071	J194	2531214.873	38465371.021	J257	2531283.176	38465858.687	J320	2531284.143	38465920.917	J383	2531269.635	38465980.893
J16	2531070.743	38463316.281	169	2531099.930	38464537.219	J132	2531156.588	38463818.017	J195	2531218.358	38465390.737	J258	2531283.140	38465859.671	J321	2531283.976	38465921.881	J384	2531269.327	38465981.823
J17	2531072.811	38463326.175	170	2531098.956	38464557.291	J133	2531155.035	38463797.981	J196	2531221.843	38465410.453	J259	2531283.103	38465860.655	J322	2531283.806	38465922.845	J385	2531269.016	38465982.751
J18	2531074.879	38463356.067	171	2531098.105	38464577.397	J134	2531153.382	38463777.965	J197	2531225.329	38465430.171	J260	2531283.065	38465861.637	J323	2531283.634	38465923.807	J386	2531268.702	38465983.679
J19	2531076.946	38463375.961	172	2531097.408	38464597.535	J135	2531151.638	38463757.965	J198	2531229.043	38465449.835	J261	2531283.026	38465862.619	J324	2531283.459	38465924.767	J387	2531268.384	38465984.605
J10	2531079.014	38463395.853	173	2531096.898	38464617.709	J136	2531149.814	38463737.981	J199	2531233.443	38465469.345	J262	2531282.986	38465863.603	J325	2531283.282	38465925.729	J388	2531268.064	38465985.529
J11	2531081.082	38463415.745	174	2531096.608	38464637.915	J137	2531147.923	38463718.015	J200	2531238.373	38465491.207	J263	2531282.945	38465864.585	J326	2531283.103	38465926.689	J389	2531267.740	38465986.453
J12	2531083.149	38463435.639	175	2531096.570	38464658.149	J138	2531145.976	38463698.063	J201	2531242.239	38465508.855	J264	2531282.903	38465865.565	J327	2531282.922	38465927.649	J390	2531267.414	38465987.375
J13	2531085.217	38463455.531	176	2531096.813	38464678.401	J139	2531143.982	38463678.125	J202	2531246.604	38465527.319	J265	2531282.859	38465866.547	J328	2531282.738	38465928.609	J391	2531267.084	38465988.297
J14	2531082.233	38463455.841	177	2531097.346	38464698.647	J140	2531143.822	38463676.555	J203	2531250.910	38465547.251	J266	2531282.814	38465867.527	J329	2531282.551	38465929.569	J392	2531266.751	38465989.217
J15	2531086.369	38463495.627	178	2531098.168	38464718.885	J141	2531141.953	38463658.201	J204	2531255.126	38465566.659	J267	2531282.762	38465868.507	J330	2531282.363	38465930.527	J393	2531266.415	38465990.135
J16	2531080.401	38463496.247	179	2531099.279	38464739.107	J142	2531139.901	38463638.289	J205	2531259.224	38465586.049	J268	2531282.722	38465869.487	J331	2531282.172	38465931.485	J394	2531266.076	38465991.053
J17	2531082.468	38463516.141	180	2531100.679	38464759.313	J143	2531137.836	38463618.389	J206	2531263.174	38465605.425	J269	2531282.674	38465870.467	J332	2531281.978	38465932.443	J395	2531265.733	38465991.969
J18	2531089.431	38463515.417	181	2531099.789	38464768.107	J144	2531135.768	38463598.495	J207	2531266.946	38465624.791	J270	2531282.624	38465871.445	J333	2531281.782	38465933.399	J396	2531265.388	38465992.883
J19	2531093.566	38463555.203	182	2531147.635	38464756.929	J145	2531133.701	38463578.603	J208	2531270.512	38465654.151	J271	2531282.573	38465872.425	J334	2531281.584	38465934.355	J397	2531265.039	38465993.797
J20	2531095.556	38463554.995	183	2531146.460	38464746.125	J146	2531133.185	38463573.629	J209	2531273.844	38465663.509	J272	2531282.522	38465873.403	J335	2531281.383	38465935.311	J398	2531264.686	38465994.709
J21	2531097.875	38463577.299	184	2531143.876	38464716.465	J147	2531131.633	38463558.709	J210	2531277.261	38465685.201	J273	2531282.468	38465874.381	J336	2531281.180	38465936.267	J399	2531264.331	38465995.619
J22	2531100.360	38463601.253	185	2531142.550	38464696.841	J148	2531129.565	38463538.817	J211	2531279.210	38465692.301	J274	2531282.414	38465875.359	J337	2531280.975	38465937.221	J400	2531263.972	38465996.529
J23	2531102.346	38463621.071	186	2531141.510	38464677.199	J149	2531127.498	38463518.925	J212	2531280.736	38465721.815	J275	2531282.358	38465876.335	J338	2531280.767	38465938.175	J401	2531263.610	38465997.437
J24	2531104.237	38463640.895	187	2531140.753	38464657.537	J150	2531125.430	38463499.031	J213	2531281.968	38465741.335	J276	2531282.300	38465877.311	J339	2531280.557	38465939.129	J402	2531263.245	38465998.343
J25	2531106.033	38463660.729	188	2531140.266	38464637.847	J151	2531123.362	38463479.139	J214	2531282.906	38465760.857	J277	2531282.242	38465878.287	J340	2531280.344	38465940.081	J403	2531262.877	38465999.249
J26	2531107.735	38463680.573	189	2531140.033	38464618.131	J152	2531121.294	38463459.245	J215	2531283.551	38465780.375	J278	2531282.182	38465879.263	J341	2531280.129	38465941.033	J404	2531262.505	38466000.153
J27	2531109.343	38463700.423	190	2531140.036	38464598.395	J153	2531119.227	38463439.353	J216	2531283.902	38465799.887	J279	2531282.120	38465880.239	J342	2531279.912	38465941.985	J405	2531262.130	38466001.057
J28	2531110.856	38463720.281	191	2531140.259	38464578.639	J154	2531117.159	38463419.459	J217	2531283.960	38465819.387	J280	2531282.057	38465881.213	J343	2531279.692	38465942.937	J406	2531261.752	38466001.957
J29	2531112.275	38463740.145	192	2531140.684	38464558.865	J155	2531115.091	38463399.567	J218	2531283.948	38465820.171	J281	2531281.993	38465882.187	J344	2531279.470	38465943.887	J407	2531261.371	38466002.859
J30	2531113.599	38463760.017	193	2531141.294	38464539.075	J156	2531113.024	38463379.673	J219	2531283.942	38465821.161	J282	2531281.927	38465883.161	J345	2531279.240	38465944.861	J408	2531260.986	38466003.755
J31	2531114.828	38463779.895	194	2531142.071	38464519.273	J157	2531110.956	38463359.781	J220	2531283.936	38465822.149	J283	2531281.859	38465884.135	J346	2531279.036	38465945.825	J409	2531260.598	38466004.657
J32	2531115.962	38463799.777	195	2531142.998	38464499.455	J158	2531108.888	38463339.899	J221	2531283.929	38465823.137	J284	2531281.790	38465885.109	J347	2531278.829	38465946.787	J410	2531260.208	38466005.551
J33	2531117.002	38463819.667	196	2531144.058	38464479.625	J159	2531106.820	38463319.955	J222	2531283.922	38465824.125	J285	2531281.720	38465886.083	J348	2531278.620	38465947.749	J411	2531259.813	38466006.445
J34	2531117.948	38463839.559	197	2531145.233	38464459.781	J160	2531149.723	38464776.135	J223	2531283.913	38465825.113	J286	2531281.718	38465886.141	J349	2531278.409	38465948.711	J412	2531259.416	38466007.339
J35	2531118.796	38463859.457	198	2531146.390	38464441.731	J161	2531097.745	38464788.291	J224	2531283.904	38465826.103	J287	2531281.621	38465887.117	J350	2531278.195	38465949.671	J413	2531259.016	38466008.231
J36	2531119.564	38463879.357	199	2531146.506	38464439.921	J162	2531096.947	38464796.175	J225	2531283.894	38465827.091	J288	2531281.522	38465888.087	J351	2531277.978	38465950.629	J414	2531258.612	38466009.121
J37	2531120.215	38463899.263	J100	2531147.858	38464420.407	J163	2531098.408	38464809.775	J226	2531283.883	38465828.079	J289	2531281.422	38465889.057	J352	2531277.760	38465951.589	J415	2531258.205	38466010.011
J38	2531120.781	38463919.169	J101	2531149.274	38464400.157	J164	2531098.580	38464811.351	J227	2531283.872	38465829.067	J290	2531281.320	38465890.025	J353	2531277.538	38465952.547	J416	2531257.952	38466010.897

点号	坐标		点号	坐标		点号	坐标		点号	坐标		点号	坐标		点号	坐标			
	X(m)	Y(m)		X(m)	Y(m)		X(m)	Y(m)		X(m)	Y(m)		X(m)	Y(m)		X(m)	Y(m)	X(m)	Y(m)
J497	2531214.711	38466077.203	J560	2531171.746	38466122.375	J623	2531034.715	38466221.095	J686	2530997.860	38466268.933	J749	2531793.381	38466078.921	J812	2531542.618	38466119.251		
J498	2531214.074	38466077.955	J561	2531171.031	38466123.061	J624	2531028.697	38466224.479	J687	2531045.564	38466253.983	J750	2531782.452	38466079.949	J813	2531541.645	38466119.277		
J499	2531213.434	38466078.703	J562	2531170.315	38466123.749	J625	2531017.329	38466230.723	J688	2531083.735	38466242.031	J751	2531769.395	38466081.631	J814	2531540.672	38466119.301		
J500	2531212.793	38466079.451	J563	2531169.598	38466124.435	J626	2530999.753	38466240.001	J689	2531102.837	38466236.109	J752	2531762.472	38466082.243	J815	2531539.700	38466119.321		
J501	2531212.150	38466080.199	J564	2531168.880	38466125.119	J627	2530981.995	38466248.927	J690	2531126.882	38466230.073	J753	2531742.524	38466084.751	J816	2531538.728	38466119.339		
J502	2531211.505	38466080.943	J565	2531168.162	38466125.805	J628	2530964.062	38466257.495	J691	2531127.958	38466229.169	J754	2531722.574	38466087.217	J817	2531537.756	38466119.351		
J503	2531210.858	38466081.687	J566	2531167.442	38466126.487	J629	2530943.433	38466266.823	J692	2531141.143	38466225.275	J755	2531709.576	38466090.231	J818	2531536.784	38466119.363		
J504	2531210.209	38466082.429	J567	2531166.722	38466127.169	J630	2530925.012	38466274.957	J693	2531160.351	38466220.151	J756	2531702.732	38466099.373	J819	2531535.813	38466119.369		
J505	2531209.558	38466083.171	J568	2531166.001	38466127.851	J631	2530906.471	38466282.701	J694	2531189.339	38466212.417	J757	2531694.785	38466091.377	J820	2531534.843	38466119.373		
J506	2531208.906	38466083.911	J569	2531165.279	38466128.531	J632	2530903.682	38466283.815	J695	2531229.456	38466201.921	J758	2531687.811	38466092.361	J821	2531533.872	38466119.373		
J507	2531208.252	38466084.649	J570	2531164.556	38466129.211	J633	2530900.683	38466280.223	J696	2531247.387	38466197.229	J759	2531687.333	38466097.447	J822	2531532.902	38466119.369		
J508	2531207.597	38466085.387	J571	2531163.832	38466129.891	J634	2530893.863	38466282.689	J697	2531248.274	38466196.997	J760	2531683.674	38466098.133	J823	2531531.932	38466119.361		
J509	2531206.939	38466086.123	J572	2531163.108	38466130.569	J635	2530886.355	38466285.341	J698	2531275.512	38466189.891	J761	2531663.930	38466101.583	J824	2531530.963	38466119.351		
J510	2531206.280	38466086.859	J573	2531162.382	38466131.245	J636	2530867.614	38466292.435	J699	2531304.555	38466182.335	J762	2531661.593	38466102.005	J825	2531529.994	38466119.337		
J511	2531205.620	38466087.593	J574	2531161.656	38466131.921	J637	2530848.715	38466299.021	J700	2531355.553	38466170.043	J763	2531644.215	38466105.191	J826	2531529.026	38466119.319		
J512	2531204.958	38466088.325	J575	2531160.929	38466132.597	J638	2530829.654	38466305.079	J701	2531389.251	38466163.427	J764	2531624.512	38466108.871	J827	2531528.058	38466119.297		
J513	2531204.294	38466089.057	J576	2531160.201	38466133.271	J639	2530810.847	38466311.963	J702	2531303.224	38466160.055	J765	2531613.030	38466111.001	J828	2531527.090	38466119.273		
J514	2531203.628	38466089.787	J577	2531159.472	38466133.943	J640	2530797.255	38466316.745	J703	2531431.249	38466154.251	J766	2531604.790	38466112.485	J829	2531526.123	38466119.243		
J515	2531202.962	38466090.517	J578	2531158.743	38466134.617	J641	2530796.016	38466317.161	J704	2531446.346	38466151.633	J767	2531587.733	38466115.305	J830	2531525.157	38466119.211		
J516	2531202.293	38466091.245	J579	2531158.012	38466135.287	J642	2530791.924	38466318.469	J705	2531462.513	38466148.653	J768	2531584.653	38466115.701	J831	2531524.191	38466119.173		
J517	2531201.623	38466091.971	J580	2531157.281	38466135.959	J643	2530772.802	38466324.387	J706	2531464.161	38466151.645	J769	2531583.672	38466115.825	J832	2531523.225	38466119.133		
J518	2531200.952	38466092.697	J581	2531156.549	38466136.627	J644	2530753.729	38466330.525	J707	2531488.293	38466145.544	J770	2531582.691	38466115.947	J833	2531522.260	38466119.089		
J519	2531200.279	38466093.423	J582	2531155.816	38466137.297	J645	2530736.146	38466336.111	J708	2531492.219	38466146.857	J771	2531581.710	38466116.067	J834	2531521.296	38466119.039		
J520	2531199.605	38466094.147	J583	2531155.082	38466137.965	J646	2530734.616	38466336.603	J709	2531494.159	38466151.011	J772	2531580.729	38466116.187	J835	2531520.332	38466118.987		
J521	2531198.930	38466094.869	J584	2531154.348	38466138.631	J647	2530715.813	38466343.647	J710	2531493.900	38466150.603	J773	2531579.748	38466116.303	J836	2531519.369	38466118.931		
J522	2531198.253	38466095.591	J585	2531153.612	38466139.297	J648	2530705.123	38466346.215	J711	2531500.043	38466149.773	J774	2531578.768	38466116.419	J837	2531518.405	38466118.869		
J523	2531197.575	38466096.313	J586	2531152.876	38466139.963	J649	2530698.302	38466352.731	J712	2531502.373	38466148.933	J775	2531577.787	38466116.535	J838	2531518.329	38466118.855		
J524	2531196.896	38466097.033	J587	2531152.139	38466140.627	J650	2530682.371	38466357.485	J713	2531500.913	38466144.873	J776	2531576.807	38466116.647	J839	2531517.330	38466118.831		
J525	2531196.215	38466097.751	J588	2531151.401	38466141.289	J651	2530663.303	38466361.643	J714	2531502.163	38466142.493	J777	2531575.828	38466116.759	J840	2531516.366	38466118.795		
J526	2531195.533	38466098.469	J589	2531150.662	38466141.953	J652	2530649.666	38466372.021	J715	2531505.563	38466141.423	J778	2531574.848	38466116.869	J841	2531515.403	38466118.753		
J527	2531194.850	38466099.187	J590	2531149.922	38466142.613	J653	2530632.248	38466379.801	J716	2531523.003	38466136.803	J779	2531573.868	38466116.977	J842	2531514.440	38466118.709		
J528	2531194.165	38466099.903	J591	2531149.182	38466143.275	J654	2530622.661	38466381.045	J717	2531535.981	38466134.491	J780	2531572.889	38466117.083	J843	2531513.477	38466118.659		
J529	2531193.479	38466100.617	J592	2531148.441	38466143.933	J655	2530603.825	38466389.320	J718	2531555.671	38466130.985	J781	2531571.910	38466117.187	J844	2531512.515	38466118.607		
J530	2531192.793	38466101.333	J593	2531147.699	38466144.593	J656	2530603.793	38466389.225	J719	2531614.742	38466120.469	J782	2531570.931	38466117.289	J845	2531511.553	38466118.549		
J531	2531192.105	38466102.045	J594	2531146.956	38466145.249	J657	2530601.362	38466381.994	J720	2531624.587	38466118.715	J783	2531569.952	38466117.389	J846	2531510.592	38466118.487		
J532	2531191.416	38466102.759	J595	2531146.212	38466145.907	J658	2530582.698	38466387.831	J721	2531650.078	38466114.177	J784	2531568.973	38466117.487	J847	2531509.631	38466118.419		
J533	2531190.725	38466103.471	J596	2531145.468	38466146.563	J659	2530566.342	38466393.523	J722	2531656.053	38466113.113	J785	2531567.994	38466117.583	J848	2531508.670	38466118.349		
J534	2531190.034	38466104.183	J597	2531144.722	38466147.217	J660	2530556.335	38466394.937	J723	2531673.880	38466110.345	J786	2531567.016	38466117.679	J849	2531507.711	38466118.273		
J535	2531189.342	38466104.893	J598	2531143.976	38466147.871	J661	2530546.990	38466397.853	J724	2531677.486	38466109.861	J787	2531566.038	38466117.771	J850	2531506.752	38466118.191		
J536	2531188.649	38466105.603	J599	2531143.229	38466148.525	J662	2530547.804	38466400.029	J725	2531846.476	38466083.723	J788	2531565.060	38466117.861	J851	2531505.793	38466118.107		
J537	2531187.954	38466106.311	J600	2531142.481	38466149.177	J663	2530549.048	38466404.877	J726	2531846.465	38466083.653	J789	2531564.082	38466117.949	J852	2531504.835	38466118.017		
J538	2531187.259	38466107.019	J601	2531141.733	38466149.827	J664	2530562.121	38466401.423	J727	2531873.577	38466079.659	J790	2531563.104	38466118.035	J853	2531503.878	38466117.923		
J539	2531186.563	38466107.727	J602	2531140.983	38466150.477	J665	2530591.196	38466393.103	J728	2531880.924	38466078.623	J791	2531562.127	38466118.119	J854	2531502.921	38466117.823		
J540	2531185.866	38466108.433	J603	2531140.233	38466151.127	J666	2530620.038	38466384.851	J729	2531905.838	38466073.995	J792	2531561.150	38466118.199	J855	2531501.965	38466117.719		
J541	2531185.169	38466109.139	J604	2531139.482	38466151.775	J667	2530639.266	38466379.349	J730	2531909.635	38466073.295	J793	2531560.172	38466118.279	J856	2531501.010	38466117.611		
J542	2531184.470	38466109.843	J605	2531138.730	38466152.423	J668	2530668.109	38466371.095	J731	2531915.204	38466072.253	J794	2531559.196	38466118.355	J857	2531500.055	38466117.497		
J543	2531183.771	38466110.547	J606	2531137.977	38466153.069	J669	2530689.221	38466365.053	J732	2531932.572	38466068.609	J795	2531558.219	38466118.429	J858	2531499.101	38466117.377		
J544	2531183.070	38466111.249	J607	2531137.224	38466153.715	J670	2530690.991	38466363.413	J733	2531940.377	38466067.301	J796	2531						

界址点坐标		坐标		点号		坐标		点号		坐标		点号		坐标		点号		坐标		点号																																									
		X(m)	Y(m)	J936	X(m)	Y(m)	J1060	X(m)	Y(m)	J1123	X(m)	Y(m)	J1186	X(m)	Y(m)	J1249	X(m)	Y(m)	J1250	X(m)	Y(m)	J1251																																							
																							J935	J936	J937	J938	J939	J940	J941	J942	J943	J944	J945	J946	J947	J948	J949	J950	J951	J952	J953	J954	J955	J956	J957	J958	J959	J960	J961	J962	J963	J964	J965	J966	J967	J968	J969	J970	J971	J972	J973
		2531238.218	38465263.245	J997	2531381.420	38466228.801	J1060	2531330.353	38466364.147	J1123	2531220.074	38466771.962	J1186	2531232.150	38466834.192	J1249	2531247.204	38466895.770																																											
		2531233.818	38465243.735	J998	2531377.862	38466232.275	J1061	2531331.036	38466364.483	J1124	2531220.242	38466772.954	J1187	2531232.366	38466835.175	J1250	2531247.467	38466896.741																																											
		2531229.419	38465224.225	J999	2531340.458	38466240.609	J1062	2531331.885	38466364.909	J1125	2531220.411	38466773.946	J1188	2531232.582	38466836.158	J1251	2531247.730	38466897.712																																											
		2531225.019	38465204.715	J1000	2531330.288	38466242.679	J1063	2531332.731	38466365.343	J1126	2531220.581	38466774.938	J1189	2531232.800	38466837.140	J1252	2531247.994	38466898.683																																											
		2531222.649	38465194.209	J1001	2531304.317	38466249.637	J1064	2531333.573	38466365.781	J1127	2531220.752	38466775.930	J1190	2531233.018	38466838.123	J1253	2531248.259	38466899.654																																											
		2531383.313	38466028.635	J939	2531220.619	38465185.205	J1002	2531265.677	38466259.983	J1065	2531134.412	38466366.227	J1128	2531220.923	38466776.922	J1191	2531233.236	38466839.105	J1254	2531248.525	38466900.625																																								
		2531380.180	38466017.189	J940	2531216.219	38465165.695	J1003	2531227.094	38466260.743	J1066	2531135.248	38466366.679	J1129	2531221.095	38466777.913	J1192	2531233.456	38466840.087	J1255	2531248.792	38466901.595																																								
		2531378.580	38466009.887	J941	2531211.819	38465146.185	J1004	2531226.893	38466269.283	J1067	2531136.080	38466367.137	J1130	2531221.268	38466778.905	J1193	2531233.676	38466841.069	J1256	2531249.059	38466902.563																																								
		2531375.364	38465990.533	J942	2531207.419	38465126.675	J1005	2531222.823	38466271.303	J1068	2531136.909	38466367.601	J1131	2531221.441	38466779.896	J1194	2531233.897	38466842.051	J1257	2531249.327	38466903.535																																								
		2531374.531	38465984.297	J943	2531203.019	38465107.163	J1006	2531219.606	38466272.161	J1069	2531137.734	38466368.073	J1132	2531221.616	38466780.887	J1195	2531234.119	38466843.032	J1258	2531249.596	38466904.505																																								
		2531373.620	38465977.039	J944	2531198.619	38465087.653	J1007	2531198.044	38466277.923	J1070	2531138.555	38466368.551	J1133	2531221.791	38466781.878	J1196	2531234.342	38466844.014	J1259	2531249.865	38466905.474																																								
		2531372.862	38465970.807	J945	2531194.219	38465068.143	J1008	2531172.962	38466284.623	J1071	2531139.373	38466369.033	J1134	2531221.967	38466782.869	J1197	2531234.565	38466844.995	J1260	2531250.135	38466906.444																																								
		2531371.566	38465959.671	J946	2531189.819	38465048.633	J1009	2531160.862	38466283.743	J1072	2531140.186	38466369.523	J1135	2531222.143	38466783.859	J1198	2531234.789	38466845.976	J1261	2531250.406	38466907.413																																								
		2531370.557	38465950.991	J947	2531185.422	38465029.131	J1010	2531149.740	38466292.165	J1073	2531140.997	38466370.021	J1136	2531222.321	38466784.850	J1199	2531235.014	38466846.957	J1262	2531250.678	38466908.382																																								
		2531368.160	38465930.405	J948	2531181.054	38465009.655	J1011	2531129.671	38466297.959	J1074	2531141.803	38466370.523	J1137	2531222.499	38466785.840	J1200	2531235.239	38466847.937	J1263	2531250.950	38466909.351																																								
		2531371.566	38465928.577	J949	2531176.311	38464990.227	J1012	2531120.036	38466300.635	J1075	2531142.605	38466371.031	J1138	2531222.678	38466786.831	J1201	2531235.465	38466848.918	J1264	2531251.223	38466910.319																																								
		2531365.988	38465910.173	J950	2531171.954	38464970.885	J1013	2531096.991	38466306.851	J1076	2531143.404	38466371.545	J1139	2531222.857	38466787.821	J1202	2531235.692	38466849.898	J1265	2531251.497	38466911.287																																								
		2531365.164	38465903.395	J951	2531167.397	38464951.547	J1014	2531077.598	38466311.737	J1077	2531144.198	38466372.067	J1140	2531223.038	38466788.811	J1203	2531235.920	38466850.879	J1266	2531251.772	38466912.255																																								
		2531353.773	38465904.597	J952	2531162.989	38464932.203	J1015	2531067.901	38466314.181	J1078	2531144.988	38466372.593	J1141	2531223.219	38466789.801	J1204	2531236.149	38466851.859	J1267	2531252.047	38466913.223																																								
		2531353.620	38465886.319	J953	2531158.762	38464912.847	J1016	2531038.906	38466328.906	J1079	2531145.775	38466373.127	J1142	2531223.401	38466790.790	J1205	2531236.378	38466852.838	J1268	2531252.323	38466914.191																																								
		2531353.768	38465883.765	J954	2531154.744	38464893.475	J1017	2531029.264	38466324.499	J1080	2531146.557	38466373.667	J1143	2531223.583	38466791.780	J1206	2531236.608	38466853.818	J1269	2531252.600	38466915.159																																								
		2531353.748	38465873.671	J955	2531150.967	38464874.077	J1018	2531009.975	38466329.779	J1081	2531147.335	38466374.211	J1144	2531223.767	38466792.769	J1207	2531236.839	38466854.798	J1270	2531252.878	38466916.126																																								
		2531353.688	38465863.571	J956	2531147.459	38464854.647	J1019	2530988.380	38466335.699	J1082	2531148.109	38466374.763	J1145	2531223.951	38466793.759	J1208	2531237.070	38466855.777	J1271	2531253.156	38466917.093																																								
		2531353.570	38465853.475	J957	2531144.344	38464835.147	J1020	2530977.367	38466338.371	J1083	2531148.878	38466375.319	J1146	2531224.136	38466794.748	J1209	2531237.302	38466856.756	J1272	2531253.435	38466918.060																																								
		2531353.378	38465843.379	J958	2531141.856	38464815.557	J1021	2530913.381	38466355.637	J1084	2531149.644	38466375.883	J1147	2531224.321	38466795.737	J1210	2531237.536	38466857.735	J1273	2531253.715	38466919.026																																								
		2531353.093	38465833.285	J959	2531140.810	38464806.573	J1022	2530884.419	38466363.479	J1085	2531150.404	38466376.451	J1148	2531224.508	38466796.726	J1211	2531237.769	38466858.714	J1274	2531253.995	38466920.993																																								
		2531352.708	38465823.195	J960	2531140.673	38464805.317	J1023	2530858.397	38466370.527	J1086	2531151.161	38466377.025	J1149	2531224.695	38466797.714	J1212	2531238.004	38466859.692	J1275	2531254.277	38466920.959																																								
		2531352.222	38465813.109	J961	2531140.093	38464800.001	J1024	2530833.918	38466377.511	J1087	2531151.913	38466377.607	J1150	2531224.883	38466798.703	J1213	2531238.239	38466860.671	J1276	2531254.559	38466921.925																																								
		2531351.468	38465803.039	J962	2531151.948	38464796.593	J1025	2530833.742	38466376.933	J1088	2531152.661	38466378.193	J1151	2531225.072	38466799.691	J1214	2531238.475	38466861.649	J1277	2531254.841	38466922.891																																								
		2531350.615	38465792.979	J963	2532034.795	38466057.043	J1026	2530822.832	38466380.243	J1089	2531153.404	38466378.785	J1152	2531225.261	38466800.680	J1215	2531238.712	38466862.627	J1278	2531255.125	38466923.856																																								
		2531349.661	38465782.929	J964	2532020.922	38466057.619	J1027	2530821.298	38466381.111	J1090	2531154.142	38466379.381	J1153	2531225.451	38466801.668	J1216	2531238.949	38466863.605	J1279	2531255.409	38466924.821																																								
		2531348.606	38465772.893	J965	2532000.975	38466060.223	J1028	2530809.142	38466386.441	J1091	2531154.876	38466379.985	J1154	2531225.642	38466802.656	J1217	2531239.187	38466864.583	J1280	2531255.694	38466925.787																																								
		2531348.158	38465768.991	J966	2532000.254	38466060.297	J1029	2530772.849	38466396.367	J1092	2531155.605	38466380.595	J1155	2531225.834	38466803.644	J1218	2531239.426	38466865.560	J1281	2531255.980	38466926.751																																								
		2531347.454	38465762.871	J967	2532002.031	38466060.131	J1030	2530741.390	38466404.959	J1093	2531156.330	38466381.209	J1156	2531226.026	38466804.631	J1219	2531239.666	38466866.537	J1282	2531256.266	38466927.716																																								
		2531346.209	38465752.867	J968	2532005.483	38466059.807	J1031	2530743.875	38466413.718	J1094	2531157.049	38466381.829	J1157	2531226.220	38466805.619	J1220	2531239.907	38466867.515	J1283	2531256.553	3846																																								

界址点坐标		点号	坐标		点号	坐标		点号	坐标		点号	坐标		点号	坐标		点号	坐标	
			X(m)	Y(m)		X(m)	Y(m)		X(m)	Y(m)		X(m)	Y(m)		X(m)	Y(m)		X(m)	Y(m)
		J1371	2531364.93	38467224.451	J1434	2531682.312	38467803.2	J1497	2531925.192	38468534.064	J1560	2531986.281	38468597.036	J1623	2531833.07	38467964.961	J1686	2531480.325	38467299.53
		J1372	2531374.729	38467230.757	J1435	2531688.904	38467822.13	J1498	2531926.111	38468540.089	J1561	2531985.396	38468590.879	J1624	2531820.497	38467948.274	J1687	2531466.169	38467295.73
		J1373	2531373.932	38467238.816	J1436	2531701.346	38467838.14	J1499	2531926.470	38468542.482	J1562	2531984.496	38468584.723	J1625	2531817.223	38467942.435	J1688	2531462.614	38467286.3
		J1374	2531376.232	38467250.761	J1437	2531709.961	38467855.93	J1500	2531927.015	38468546.116	J1563	2531983.579	38468578.570	J1626	2531814.729	38467928.583	J1689	2531459.004	38467276.89
		J1375	2531378.441	38467259.832	J1438	2531710.002	38467856.015	J1501	2531927.904	38468552.145	J1564	2531982.649	38468572.419	J1627	2531807.100	38467913.409	J1690	2531452.510	38467269.019
		J1376	2531377.008	38467271.410	J1439	2531715.008	38467875.613	J1502	2531928.777	38468558.177	J1565	2531981.698	38468566.271	J1628	2531806.420	38467910.022	J1691	2531448.634	38467259.765
		J1377	2531377.655	38467282.063	J1440	2531730.320	38467905.121	J1503	2531929.635	38468564.211	J1566	2531980.734	38468560.125	J1629	2531801.808	38467889.728	J1692	2531446.640	38467249.527
		J1378	2531374.864	38467293.835	J1441	2531734.662	38467910.177	J1504	2531930.477	38468570.247	J1567	2531979.755	38468553.982	J1630	2531796.536	38467869.709	J1693	2531443.907	38467239.697
		J1379	2531369.820	38467308.847	J1442	2531739.485	38467929.721	J1505	2531931.304	38468576.285	J1568	2531978.759	38468567.841	J1631	2531789.668	38467850.445	J1694	2531444.016	38467238.393
		J1380	2531371.788	38467322.186	J1443	2531745.128	38467948.851	J1506	2531932.115	38468582.326	J1569	2531977.748	38468541.703	J1632	2531778.985	38467833.081	J1695	2531438.052	38467220.309
		J1381	2531378.749	38467333.711	J1444	2531754.780	38467966.220	J1507	2531932.911	38468588.368	J1570	2531976.720	38468553.568	J1633	2531765.367	38467817.255	J1696	2531433.536	38467211.477
		J1382	2531391.954	38467339.367	J1445	2531765.648	38467983.129	J1508	2531933.692	38468594.412	J1571	2531975.678	38468529.435	J1634	2531753.286	38467807.324	J1697	2531431.269	38467207.073
		J1383	2531402.867	38467346.176	J1446	2531773.540	38468000.961	J1509	2531934.220	38468598.590	J1572	2531974.619	38468523.305	J1635	2531751.970	38467801.402	J1698	2531428.542	38467202.910
		J1384	2531422.917	38467346.463	J1447	2531773.670	38468001.255	J1510	2531934.457	38468600.459	J1573	2531973.644	38468517.177	J1636	2531743.236	38467783.219	J1699	2531424.027	38467194.109
		J1385	2531429.544	38467352.982	J1448	2531775.716	38468021.760	J1511	2531935.206	38468606.507	J1574	2531972.454	38468511.053	J1637	2531729.788	38467769.525	J1700	2531419.515	38467185.321
		J1386	2531442.310	38467357.381	J1449	2531782.213	38468040.443	J1512	2531935.940	38468612.557	J1575	2531971.348	38468504.931	J1638	2531728.478	38467768.191	J1701	2531415.044	38467176.527
		J1387	2531444.853	38467363.694	J1450	2531794.334	38468056.986	J1513	2531936.659	38468618.609	J1576	2531970.226	38468508.812	J1639	2531724.149	38467767.689	J1702	2531410.698	38467167.686
		J1388	2531446.854	38467373.955	J1451	2531803.127	38468074.859	J1514	2531937.362	38468624.663	J1577	2531969.089	38468492.696	J1640	2531717.278	38467751.367	J1703	2531406.315	38467158.879
		J1389	2531443.456	38467387.088	J1452	2531808.257	38468094.079	J1515	2531938.050	38468630.319	J1578	2531967.935	38468486.583	J1641	2531716.660	38467724.524	J1704	2531401.980	38467150.064
		J1390	2531444.620	38467397.795	J1453	2531814.289	38468112.951	J1516	2531938.124	38468631.791	J1579	2531966.766	38468480.473	J1642	2531717.744	38467728.428	J1705	2531397.885	38467141.147
		J1391	2531447.276	38467407.708	J1454	2531812.551	38468134.463	J1517	2531938.238	38468632.415	J1580	2531965.582	38468474.365	J1643	2531712.283	38467718.971	J1706	2531393.604	38467132.336
		J1392	2531446.941	38467419.212	J1455	2531826.064	38468150.915	J1518	2531938.267	38468632.636	J1581	2531964.381	38468468.261	J1644	2531709.372	38467710.145	J1707	2531389.823	38467123.306
		J1393	2531449.108	38467429.385	J1456	2531827.835	38468171.014	J1519	2531938.422	38468632.323	J1582	2531963.165	38468462.161	J1645	2531699.549	38467692.658	J1708	2531386.001	38467114.316
		J1394	2531469.819	38467429.699	J1457	2531836.960	38468188.956	J1520	2531945.774	38468712.073	J1583	2531961.933	38468456.063	J1646	2531685.498	38467677.448	J1709	2531382.572	38467105.169
		J1395	2531485.092	38467432.904	J1458	2531841.264	38468208.221	J1521	2531946.103	38468716.827	J1584	2531960.686	38468449.968	J1647	2531676.837	38467671.199	J1710	2531379.258	38467095.965
		J1396	2531488.182	38467442.587	J1459	2531845.039	38468227.772	J1522	2531948.528	38468781.875	J1585	2531959.423	38468443.877	J1648	2531669.290	38467663.411	J1711	2531375.645	38467086.993
		J1397	2531495.192	38467450.185	J1460	2531848.929	38468247.150	J1523	2531950.616	38468791.717	J1586	2531958.144	38468437.789	J1649	2531662.785	38467654.789	J1712	2531369.460	38467079.013
		J1398	2531500.067	38467458.919	J1461	2531853.468	38468266.376	J1524	2531953.898	38468792.586	J1587	2531956.849	38468431.704	J1650	2531658.749	38467649.440	J1713	2531364.159	38467067.658
		J1399	2531505.107	38467467.569	J1462	2531855.651	38468283.197	J1525	2531953.601	38468781.875	J1588	2531955.539	38468425.623	J1651	2531652.397	38467632.753	J1714	2531357.210	38467062.937
		J1400	2531510.143	38467476.213	J1463	2531856.012	38468286.051	J1526	2531954.354	38468831.386	J1589	2531954.213	38468419.545	J1652	2531641.065	38467616.127	J1715	2531352.378	38467054.325
		J1401	2531512.662	38467480.537	J1464	2531856.527	38468288.022	J1527	2531954.317	38468844.874	J1590	2531952.817	38468413.470	J1653	2531634.165	38467593.145	J1716	2531350.006	38467044.745
		J1402	2531512.785	38467480.748	J1465	2531857.272	38468290.883	J1528	2531957.476	38468847.834	J1591	2531951.572	38468407.399	J1654	2531621.236	38467587.463	J1717	2531347.396	38467035.725
		J1403	2531516.929	38467487.817	J1466	2531858.014	38468293.746	J1529	2531959.773	38468850.713	J1592	2531948.754	38468395.267	J1655	2531618.492	38467577.163	J1718	2531344.417	38467025.954
		J1404	2531520.253	38467493.488	J1467	2531858.751	38468296.609	J1530	2531943.092	38468861.066	J1593	2531952.624	38468392.460	J1656	2531610.699	38467564.319	J1719	2531340.550	38467016.959
		J1405	2531522.270	38467498.079	J1468	2531859.485	38468299.473	J1531	2531941.365	38468863.993	J1594	2531952.642	38468389.192	J1657	2531608.101	38467560.037	J1720	2531338.580	38467007.290
		J1406	2531527.323	38467509.578	J1469	2531860.216	38468302.339	J1532	2531939.602	38468866.981	J1595	2531976.396	38468383.670	J1658	2531600.745	38467542.184	J1721	2531337.486	38466997.344
		J1407	2531528.321	38467511.850	J1470	2531860.920	38468305.117	J1533	2531937.463	38468870.589	J1596	2531976.212	38468382.666	J1659	2531605.819	38467521.611	J1722	2531331.909	38466988.924
		J1408	2531533.133	38467526.280	J1471	2531860.940	38468305.406	J1534	2531938.498	38468871.761	J1597	2531970.176	38468369.430	J1660	2531603.537	38467518.751	J1723	2531325.940	38466980.589
		J1409	2531534.729	38467531.094	J1472	2531860.560	38468325.619	J1535	2531937.800	38468873.712	J1598	2531967.105	38468349.204	J1661	2531603.770	38467517.037	J1724	2531323.794	38466975.669
		J1410	2531536.135	38467536.009	J1473	2531870.844	38468343.373	J1536	2531934.364	38468895.153	J1599	2531961.529	38468329.589	J1662	2531597.991	38467511.799	J1725	2531322.747	38466973.419
		J1411	2531540.354	38467550.755	J1474	2531877.992	38468350.466	J1537	2531937.244	38468903.954	J1600	2531955.508	38468311.657	J1663	2531588.262	38467502.982	J1726	2531317.848	38466972.875
		J1412	2531544.608	38467554.156	J1475	2531877.438	38468362.081	J1538	2531944.758	38468908.713	J1601	2531955.932	38468309.988	J1664	2531574.592	38467492.911	J1727	2531314.923	38466963.486
		J1413	2531548.077	38467556.929	J1476	2531877.135	38468382.365	J1539	2531971.069	38468909.083	J1602	2531949.715	38468290.564	J1665	2531573.017	38467491.755	J1728	2531312.069	38466954.075
		J1414	2531557.369	38467564.359	J1477	2531886.581	38468400.481	J1540	2531985.880	38468902.274	J1603	2531941.960	38468271.591	J1666	2531579.680	38467467.555	J1729	2531309.287	38466944.643
		J1415	2531560.725	38467585.226	J1478	2531893.807	38468419.145	J1541	2531996.483	3846892.791	J1604	2531934.570	38468251.704	J1667	2531561.603	38467459.277	J1730	2531306.577	38466935.196
		J1416	2531571.290	38467602.260	J1479	2531895.906	38468424.698	J1542	2532003.726	38468889.767	J1605	2531930.559	38468232.522						

界址点坐标		坐标		坐标		坐标		坐标		坐标		坐标		坐标			
		X(m)	Y(m)	X(m)	Y(m)	X(m)	Y(m)	X(m)	Y(m)	X(m)	Y(m)	X(m)	Y(m)	X(m)	Y(m)		
J1808	2531269.312	38466725.827	J1871	2531266.673	38466663.29	J1934	2531267.079	384666602.18	J1997	2531272.019	38466540.013	J2060	2531284.104	38466479.151	J2123	2531304.674	38466421.767
J1809	2531269.247	38466724.835	J1872	2531266.656	38466662.29	J1935	2531267.115	384666601.19	J1998	2531272.148	38466539.035	J2061	2531284.366	38466478.201	J2124	2531305.076	38466420.869
J1810	2531269.182	38466723.843	J1873	2531266.639	38466661.3	J1936	2531267.152	384666600.2	J1999	2531272.279	38466538.055	J2062	2531284.631	38466477.253	J2125	2531305.480	38466419.971
J1811	2531269.119	38466722.852	J1874	2531266.622	38466660.3	J1937	2531267.190	38466559.2	J2000	2531272.412	38466537.077	J2063	2531284.898	38466476.307	J2126	2531305.887	38466419.075
J1749	2531276.126	38466798.037	J1812	2531269.056	38466721.860	J1875	2531266.607	38466659.311	J1938	2531267.230	38466558.213	J2001	2531272.547	38466536.099	J2064	2531285.167	38466475.359
J1750	2531276.006	38466797.051	J1813	2531268.993	38466720.868	J1876	2531266.592	38466658.317	J1939	2531267.270	38466559.221	J2002	2531272.684	38466535.119	J2065	2531285.438	38466474.413
J1751	2531275.886	38466796.064	J1814	2531268.932	38466719.877	J1877	2531266.579	38466657.323	J1940	2531267.312	38466559.229	J2003	2531272.822	38466534.143	J2066	2531285.712	38466473.469
J1752	2531275.767	38466795.077	J1815	2531268.871	38466718.885	J1878	2531266.576	38466656.714	J1941	2531267.355	38466559.239	J2004	2531272.963	38466533.165	J2067	2531285.988	38466472.523
J1753	2531275.649	38466794.091	J1816	2531268.811	38466717.893	J1879	2531266.566	38466655.329	J1942	2531267.399	38466559.247	J2005	2531273.105	38466532.187	J2068	2531286.267	38466471.581
J1754	2531275.531	38466793.104	J1817	2531268.751	38466716.901	J1880	2531266.553	38466655.335	J1943	2531267.445	38466559.257	J2006	2531273.249	38466531.211	J2069	2531286.548	38466470.637
J1755	2531275.415	38466792.117	J1818	2531268.693	38466715.909	J1881	2531266.542	38466654.343	J1944	2531267.492	38466559.267	J2007	2531273.395	38466530.235	J2070	2531286.831	38466469.695
J1756	2531275.299	38466791.130	J1819	2531268.635	38466714.917	J1882	2531266.531	38466653.349	J1945	2531267.540	38466559.275	J2008	2531273.543	38466529.259	J2071	2531287.116	38466468.753
J1757	2531275.183	38466790.143	J1820	2531268.578	38466713.925	J1883	2531266.521	38466652.355	J1946	2531267.589	38466559.285	J2009	2531273.693	38466528.283	J2072	2531287.404	38466467.811
J1758	2531275.069	38466789.156	J1821	2531268.522	38466712.933	J1884	2531266.512	38466651.361	J1947	2531267.639	38466559.295	J2010	2531273.845	38466527.307	J2073	2531287.694	38466466.871
J1759	2531274.955	38466788.169	J1822	2531268.466	38466711.941	J1885	2531266.503	38466650.367	J1948	2531267.691	38466558.305	J2011	2531273.998	38466526.333	J2074	2531287.986	38466465.931
J1760	2531274.842	38466787.182	J1823	2531268.411	38466710.948	J1886	2531266.495	38466649.373	J1949	2531267.744	38466558.315	J2012	2531274.154	38466525.357	J2075	2531288.281	38466464.991
J1761	2531274.730	38466786.195	J1824	2531268.357	38466709.956	J1887	2531266.488	38466648.381	J1950	2531267.798	38466558.325	J2013	2531274.312	38466524.383	J2076	2531288.578	38466464.053
J1762	2531274.619	38466785.207	J1825	2531268.300	38466708.964	J1888	2531266.482	38466647.387	J1951	2531267.854	38466558.335	J2014	2531274.471	38466523.409	J2077	2531288.877	38466463.117
J1763	2531274.508	38466784.220	J1826	2531268.252	38466707.972	J1889	2531266.476	38466646.393	J1952	2531267.911	38466558.345	J2015	2531274.633	38466522.437	J2078	2531289.178	38466462.179
J1764	2531274.398	38466783.232	J1827	2531268.200	38466706.979	J1890	2531266.472	38466645.399	J1953	2531267.970	38466558.355	J2016	2531274.796	38466521.463	J2079	2531289.482	38466461.243
J1765	2531274.289	38466782.244	J1828	2531268.149	38466705.987	J1891	2531266.468	38466644.405	J1954	2531268.029	38466558.367	J2017	2531274.962	38466520.491	J2080	2531289.788	38466460.307
J1766	2531274.180	38466781.257	J1829	2531268.098	38466704.994	J1892	2531266.464	38466643.411	J1955	2531268.090	38466558.377	J2018	2531275.130	38466519.519	J2081	2531290.096	38466459.373
J1767	2531274.073	38466780.269	J1830	2531268.049	38466704.002	J1893	2531266.462	38466642.419	J1956	2531268.153	38466558.389	J2019	2531275.299	38466518.547	J2082	2531290.406	38466458.439
J1768	2531273.966	38466779.281	J1831	2531268.000	38466703.009	J1894	2531266.460	38466641.425	J1957	2531268.216	38466559.399	J2020	2531275.471	38466517.575	J2083	2531290.719	38466457.507
J1769	2531273.860	38466778.293	J1832	2531267.952	38466702.017	J1895	2531266.459	38466640.431	J1958	2531268.282	38466558.411	J2021	2531275.644	38466516.605	J2084	2531291.034	38466456.573
J1770	2531273.754	38466777.305	J1833	2531267.905	38466701.024	J1896	2531266.459	38466639.437	J1959	2531268.348	38466557.423	J2022	2531275.820	38466515.635	J2085	2531291.352	38466455.643
J1771	2531273.649	38466776.317	J1834	2531267.859	38466700.032	J1897	2531266.460	38466638.443	J1960	2531268.416	38466557.435	J2023	2531275.998	38466514.665	J2086	2531291.671	38466454.711
J1772	2531273.545	38466775.328	J1835	2531267.813	38466699.039	J1898	2531266.461	38466637.449	J1961	2531268.486	38466557.447	J2024	2531276.178	38466513.695	J2087	2531291.993	38466453.781
J1773	2531273.442	38466774.340	J1836	2531267.768	38466698.046	J1899	2531266.462	38466636.953	J1962	2531268.566	38466557.459	J2025	2531276.360	38466512.727	J2088	2531292.317	38466452.853
J1774	2531273.402	38466773.972	J1837	2531267.724	38466697.054	J1900	2531266.464	38466635.959	J1963	2531268.629	38466557.471	J2026	2531276.544	38466511.757	J2089	2531292.644	38466451.923
J1775	2531285.597	38466780.446	J1838	2531267.680	38466696.061	J1901	2531266.468	38466634.963	J1964	2531268.702	38466557.483	J2027	2531276.730	38466510.789	J2090	2531292.972	38466450.997
J1776	2531297.412	38466788.511	J1839	2531267.638	38466695.068	J1902	2531266.472	38466633.969	J1965	2531268.778	38466557.495	J2028	2531276.918	38466509.821	J2091	2531293.304	38466450.069
J1777	2531304.930	38466788.043	J1840	2531267.596	38466694.075	J1903	2531266.477	38466632.973	J1966	2531268.854	38466557.507	J2029	2531277.108	38466508.855	J2092	2531293.637	38466449.143
J1778	2531293.404	38466769.576	J1841	2531267.555	38466693.082	J1904	2531266.482	38466631.979	J1967	2531268.932	38466557.521	J2030	2531277.300	38466507.887	J2093	2531293.972	38466448.217
J1779	2531283.530	38466762.481	J1842	2531267.514	38466692.089	J1905	2531266.489	38466630.985	J1968	2531269.012	38466558.533	J2031	2531277.495	38466506.921	J2094	2531294.310	38466447.293
J1780	2531271.936	38466758.969	J1843	2531267.475	38466691.097	J1906	2531266.496	38466629.991	J1969	2531269.093	38466557.547	J2032	2531277.692	38466505.957	J2095	2531294.650	38466446.371
J1781	2531271.894	38466758.516	J1844	2531267.436	38466690.104	J1907	2531266.504	38466628.995	J1970	2531269.176	38466556.561	J2033	2531277.890	38466504.991	J2096	2531294.992	38466445.447
J1782	2531271.804	38466757.527	J1845	2531267.398	38466689.111	J1908	2531266.513	38466628.001	J1971	2531269.260	38466556.575	J2034	2531278.091	38466504.027	J2097	2531295.337	38466444.525
J1783	2531271.714	38466756.537	J1846	2531267.360	38466688.118	J1909	2531266.523	38466627.007	J1972	2531269.346	38466556.589	J2035	2531278.294	38466503.063	J2098	2531295.683	38466443.605
J1784	2531271.626	38466755.547	J1847	2531267.324	38466687.125	J1910	2531266.533	38466626.013	J1973	2531269.433	38466556.603	J2036	2531278.500	38466502.099	J2099	2531296.032	38466442.685
J1785	2531271.538	38466754.557	J1848	2531267.288	38466686.132	J1911	2531266.545	38466625.019	J1974	2531269.522	38466556.617	J2037	2531278.707	38466501.135	J2100	2531296.384	38466441.765
J1786	2531271.450	38466753.568	J1849	2531267.253	38466685.139	J1912	2531266.558	38466624.025	J1975	2531269.612	38466556.631	J2038	2531278.917	38466500.173	J2101	2531296.737	38466440.847
J1787	2531271.364	38466752.578	J1850	2531267.219	38466684.145	J1913	2531266.571	38466623.031	J1976	2531269.704	38466556.647	J2039	2531279.129	38466499.219	J2102	2531296.911	38466439.999
J1788	2531271.278	38466751.588	J1851	2531267.185	38466683.152	J1914	2531266.585	38466622.037	J1977	2531269.798	38466556.661	J2040	2531279.349	38466498.251	J2103	2531297.093	38466439.929
J1789	2531271.193	38466750.598	J1852	2531267.152	38466682.159	J1915	2531266.600	38466621.043	J1978	2531269.893	38466556.677	J2041	2531279.559	38466497.289	J2104	2531297.451	38466439.011
J1790	2531271.108	38466749.607	J1853	2531267.120	38466681.166	J1916	2531266.616	38466620.049	J1979	2531269.990	38466556.691	J2042	2531279.778	38466496.329	J2105	2531297.811	38466438.097
J1791	2531271.025	38466748.617	J1854	2531267.089	38466680.173	J1917	2531266.633	38466619.055	J1980	2531270.088	38466556.707	J2043	2531279.999	38466495.369	J2106	2531298.173	38466437.181
J1792	2531270.942	38466747.627	J1855	2531267													

界址点坐标		点号	坐标		点号	坐标		点号	坐标		点号	坐标		点号	坐标		点号	坐标		
			X(m)	Y(m)		X(m)	Y(m)		X(m)	Y(m)		X(m)	Y(m)		X(m)	Y(m)		X(m)	Y(m)	
		J2245	2531757.753	38466163.331	J2308	2532458.395	38472385.651	J2371	2532544.863	38473018.153	J2434	2532603.335	38473033.849	J2497	2532779.616	38473458.681	J2560	2532777.645	38473520.917	
		J2246	2531758.278	38466163.227	J2309	2532460.020	38472389.189	J2372	2532545.800	38473018.301	J2435	2532604.263	38473034.175	J2498	2532779.601	38473459.669	J2561	2532777.598	38473521.907	
		J2247	2531777.445	38466159.327	J2310	2532460.898	38472391.103	J2373	2532546.735	38473018.453	J2436	2532605.192	38473034.501	J2499	2532779.587	38473460.655	J2562	2532777.550	38473522.895	
		J2248	2531780.277	38466158.729	J2311	2532461.730	38472392.921	J2374	2532547.671	38473018.607	J2437	2532606.121	38473034.829	J2500	2532779.571	38473461.643	J2563	2532777.502	38473523.885	
		J2249	2531796.487	38466152.623	J2312	2532462.979	38472395.649	J2375	2532548.605	38473018.767	J2438	2532607.050	38473035.159	J2501	2532779.555	38473462.631	J2564	2532777.453	38473524.873	
J2186	2531334.186	38466367.309	J2249	2531816.072	38466148.375	J2313	2532464.227	38472398.377	J2376	2532549.539	38473018.929	J2439	2532607.979	38473035.491	J2502	2532779.539	38473463.617	J2565	2532777.404	38473525.863
J2187	2531334.721	38466366.483	J2250	2531829.827	38466145.289	J2314	2532465.476	38472401.105	J2377	2532550.472	38473019.095	J2440	2532608.900	38473035.821	J2503	2532779.522	38473464.605	J2566	2532777.354	38473526.853
J2188	2531335.258	38466365.657	J2251	2531835.616	38466145.079	J2315	2532466.724	38472403.833	J2378	2532551.405	38473019.266	J2441	2532609.840	38473036.155	J2504	2532779.504	38473465.591	J2567	2532777.304	38473527.841
J2189	2531335.797	38466364.835	J2252	2531855.090	38466139.743	J2316	2532467.973	38472406.561	J2379	2532552.337	38473019.439	J2442	2532610.770	38473036.489	J2505	2532779.486	38473466.579	J2568	2532777.254	38473528.831
J2190	2531336.338	38466364.013	J2253	2531875.746	38466139.097	J2317	2532469.220	38472409.285	J2380	2532553.268	38473019.617	J2443	2532611.702	38473036.825	J2506	2532779.467	38473467.567	J2569	2532777.203	38473529.821
J2191	2531336.881	38466363.191	J2254	2531895.621	38466138.291	J2318	2532470.574	38472412.301	J2381	2532554.199	38473019.797	J2444	2532612.633	38473037.161	J2507	2532779.448	38473468.553	J2570	2532777.152	38473530.809
J2192	2531337.426	38466362.373	J2255	2531915.562	38466137.486	J2319	2532471.926	38472415.326	J2382	2532555.128	38473019.973	J2445	2532613.564	38473037.497	J2508	2532779.428	38473469.541	J2571	2532777.100	38473531.799
J2193	2531337.973	38466361.553	J2256	2531935.503	38466136.680	J2320	2532473.278	38472418.353	J2383	2532556.058	38473020.149	J2446	2532614.495	38473037.827	J2509	2532779.407	38473470.527	J2572	2532776.998	38473532.789
J2194	2531338.522	38466360.737	J2257	2531955.444	38466135.875	J2321	2532474.630	38472421.380	J2384	2532556.986	38473020.323	J2447	2532615.426	38473038.157	J2510	2532779.386	38473471.515	J2573	2532776.998	38473533.779
J2195	2531339.073	38466359.921	J2258	2531975.385	38466135.070	J2322	2532476.030	38472424.406	J2385	2532557.915	38473020.497	J2448	2532616.357	38473038.491	J2511	2532779.365	38473472.501	J2574	2532776.942	38473534.769
J2196	2531339.626	38466359.107	J2259	2531995.326	38466134.265	J2323	2532477.430	38472427.432	J2386	2532558.843	38473020.671	J2449	2532617.288	38473038.825	J2512	2532779.342	38473473.489	J2575	2532776.889	38473535.757
J2197	2531340.181	38466358.295	J2260	2532015.267	38466133.460	J2324	2532478.830	38472430.458	J2387	2532559.771	38473020.845	J2450	2532618.219	38473039.159	J2513	2532779.320	38473474.475	J2576	2532776.835	38473536.747
J2198	2531340.738	38466357.483	J2261	2532035.208	38466132.655	J2325	2532480.230	38472433.484	J2388	2532560.699	38473021.019	J2451	2532619.150	38473039.493	J2514	2532779.296	38473475.463	J2577	2532776.781	38473537.737
J2199	2531341.296	38466356.673	J2262	2532055.149	38466131.850	J2326	2532481.630	38472436.510	J2389	2532561.627	38473021.193	J2452	2532620.081	38473039.827	J2515	2532779.272	38473476.451	J2578	2532776.726	38473538.727
J2200	2531341.857	38466355.865	J2263	2532075.090	38466131.045	J2327	2532483.030	38472439.536	J2390	2532562.555	38473021.367	J2453	2532621.012	38473040.161	J2516	2532779.248	38473477.437	J2579	2532776.671	38473539.717
J2201	2531342.420	38466355.057	J2264	2532095.031	38466130.240	J2328	2532484.430	38472442.562	J2391	2532563.483	38473021.541	J2454	2532621.943	38473040.495	J2517	2532779.223	38473478.425	J2580	2532776.616	38473540.707
J2202	2531342.985	38466354.251	J2265	2532115.030	38466129.435	J2329	2532485.830	38472445.588	J2392	2532564.411	38473021.715	J2455	2532622.874	38473040.829	J2518	2532779.197	38473479.411	J2581	2532776.560	38473541.697
J2203	2531343.552	38466353.447	J2266	2532135.030	38466128.630	J2330	2532487.230	38472448.614	J2393	2532565.339	38473021.889	J2456	2532623.805	38473041.163	J2519	2532779.171	38473480.399	J2582	2532776.504	38473542.687
J2204	2531344.120	38466352.643	J2267	2532155.030	38466127.825	J2331	2532488.630	38472451.640	J2394	2532566.267	38473022.063	J2457	2532624.736	38473041.497	J2520	2532779.144	38473481.387	J2583	2532776.380	38473543.677
J2205	2531344.691	38466351.841	J2268	2532175.030	38466127.020	J2332	2532490.030	38472454.666	J2395	2532567.194	38473022.237	J2458	2532625.667	38473041.831	J2521	2532779.117	38473482.375	J2584	2532776.246	38473544.667
J2206	2531345.264	38466351.041	J2269	2532195.030	38466126.215	J2333	2532491.430	38472457.692	J2396	2532568.121	38473022.411	J2459	2532626.598	38473042.165	J2522	2532779.089	38473483.363	J2585	2532776.178	38473545.657
J2207	2531345.838	38466350.243	J2270	2532215.030	38466125.410	J2334	2532492.830	38472460.718	J2397	2532569.048	38473022.585	J2460	2532627.529	38473042.499	J2523	2532779.060	38473484.349	J2586	2532776.109	38473546.647
J2208	2531346.415	38466349.445	J2271	2532235.030	38466124.605	J2335	2532494.230	38472463.744	J2398	2532570.975	38473022.759	J2461	2532628.460	38473042.833	J2524	2532779.031	38473485.337	J2587	2532776.040	38473547.637
J2209	2531346.994	38466348.649	J2272	2532255.030	38466123.800	J2336	2532495.630	38472466.770	J2399	2532571.902	38473022.933	J2462	2532629.391	38473043.167	J2525	2532779.002	38473486.325	J2588	2532775.970	38473548.627
J2210	2531347.574	38466347.853	J2273	2532275.030	38466123.000	J2337	2532497.030	38472469.796	J2400	2532572.829	38473023.107	J2463	2532630.322	38473043.501	J2526	2532778.972	38473487.313	J2589	2532775.900	38473549.617
J2211	2531348.156	38466347.061	J2274	2532295.030	38466122.200	J2338	2532498.430	38472472.822	J2401	2532573.756	38473023.281	J2464	2532631.253	38473043.835	J2527	2532778.941	38473488.299	J2590	2532775.830	38473550.607
J2212	2531348.740	38466346.269	J2275	2532315.030	38466121.400	J2339	2532499.830	38472475.848	J2402	2532574.683	38473023.455	J2465	2532632.184	38473044.169	J2528	2532778.910	38473489.287	J2591	2532775.759	38473551.597
J2213	2531349.320	38466345.479	J2276	2532335.030	38466120.600	J2340	2532501.230	38472478.874	J2403	2532575.610	38473023.629	J2466	2532633.115	38473044.503	J2529	2532778.878	38473490.275	J2592	2532775.687	38473552.587
J2214	2531349.900	38466344.687	J2277	2532355.030	38466119.800	J2341	2532502.630	38472481.900	J2404	2532576.538	38473023.803	J2467	2532634.046	38473044.837	J2530	2532778.846	38473491.263	J2593	2532775.615	38473553.577
J2215	2531350.480	38466343.895	J2278	2532375.030	38466119.000	J2342	2532504.030	38472484.926	J2405	2532577.466	38473023.977	J2468	2532634.977	38473045.171	J2531	2532778.813	38473492.251	J2594	2532775.543	38473554.567
J2216	2531351.060	38466343.103	J2279	2532395.030	38466118.200	J2343	2532505.430	38472487.952	J2406	2532578.394	38473024.151	J2469	2532635.908	38473045.505	J2532	2532778.780	38473493.239	J2595	2532775.470	38473555.557
J2217	2531351.640	38466342.311	J2280	2532415.030	38466117.400	J2344	2532506.830	38472490.978	J2407	2532579.322	38473024.325	J2470	2532636.839	38473045.839	J2533	2532778.746	38473494.227	J2596	2532775.396	38473556.547
J2218	2531352.220	38466341.519	J2281	2532435.030	38466116.600	J2345	2532508.230	38472494.004	J2408	2532580.250	38473024.499	J2471	2532637.770	38473046.173	J2534	2532778.712	38473495.215	J2597	2532775.322	38473557.537
J2219	2531352.800	38466340.727	J2282	2532455.030	38466115.800	J2346	2532509.630	38472497.030	J2409	2532581.178	38473024.673	J2472	2532638.701	38473046.507	J2535	2532778.678	38473496.203	J2598	2532775.248	38473558.527
J2220	2531353.380	38466340.000	J2283	2532475.030	38466115.000	J2347	2532511.030	38472500.056	J2410	2532582.106	38473024.847	J2473	2532639.632	38473046.841	J2536	2532778.644	38473497.191	J2599	2532775.173	38473559.517
J2221	2531353.960	38466339.273	J2284	2532495.030	38466114.200	J2348	2532512.430	38472503.082	J2411	2532583.024	38473025.021	J2474	2532640.563	38473047.175	J2537	2532778.610	38473498.179	J2600	2532775.098	38473560.507

界址点坐标		点号	坐标		点号	坐标		点号	坐标		点号	坐标		点号	坐标		点号	坐标				
			X(m)	Y(m)		X(m)	Y(m)		X(m)	Y(m)		X(m)	Y(m)		X(m)	Y(m)		X(m)	Y(m)			
		J2682	2532741.847	38474189.661	J2745	2533236.646	38474902.675	J2808	2532823.636	38474289.889	J2871	2532821.609	38473442.311	J2934	2532904.533	38472597.801	J2997	2532553.832	38472326.095			
		J2683	2532743.013	38474192.355	J2746	2533237.239	38474898.079	J2809	2532820.158	38474282.731	J2872	2532822.669	38473421.703	J2935	2532904.146	38472595.991	J2998	2532554.817	38472324.449			
		J2684	2532735.146	38474211.791	J2747	2533239.054	38474896.069	J2810	2532820.409	38474281.867	J2873	2532822.084	38473401.497	J2936	2532899.452	38472584.973	J2999	2532558.503	38472314.037			
		J2685	2532727.525	38474232.239	J2748	2533237.608	38474885.229	J2811	2532821.372	38474278.601	J2874	2532821.965	38473381.291	J2937	2532893.501	38472574.101	J3000	2532559.150	38472300.301			
		J2686	2532726.101	38474234.351	J2749	2533231.288	38474880.019	J2812	2532822.345	38474275.343	J2875	2532821.610	38473361.089	J2938	2532883.916	38472566.655	J3001	2532555.028	38472288.269			
		J2687	2532739.289	38473919.709	J2687	2532694.403	38474262.219	J2750	2533221.127	38474879.203	J2813	2532823.330	38474272.093	J2876	2532821.494	38473340.875	J2939	2532883.553	38472566.439	J3002	2532554.788	38472287.309
		J2688	2532742.453	38473927.691	J2688	2532724.481	38474284.339	J2751	2533208.509	38474871.943	J2814	2532823.936	38474270.113	J2877	2532821.557	38473320.637	J2940	2532874.032	38472558.379	J3003	2532548.487	38472275.076
		J2689	2532743.311	38473947.951	J2689	2532740.315	38474299.745	J2752	2533207.881	38474865.529	J2815	2532823.675	38474266.989	J2878	2532821.385	38473300.391	J2941	2532863.351	38472551.885	J3004	2532558.010	38472266.047
		J2690	2532737.235	38473967.771	J2690	2532740.703	38474300.123	J2753	2533197.647	38474865.067	J2816	2532823.438	38474264.059	J2879	2532820.976	38473280.139	J2942	2532851.384	38472548.271	J3005	2532532.187	38472264.301
		J2691	2532735.798	38473987.991	J2691	2532745.462	38474318.745	J2754	2533192.420	38474859.689	J2817	2532823.211	38474261.131	J2880	2532820.337	38473259.881	J2943	2532850.277	38472547.619	J3006	2532530.759	38472264.589
		J2692	2532740.054	38474009.163	J2692	2532753.532	38474340.025	J2755	2533178.482	38474845.345	J2818	2532822.992	38474258.203	J2881	2532819.451	38473239.623	J2944	2532840.063	38472542.701	J3007	2532515.033	38472260.381
		J2693	2532739.706	38474010.283	J2693	2532771.096	38474357.847	J2756	2533164.544	38474831.001	J2819	2532822.783	38474255.275	J2882	2532818.326	38473219.367	J2945	2532827.675	38472540.497	J3008	2532511.771	38472257.871
		J2694	2532738.778	38474013.293	J2694	2532779.248	38474373.451	J2757	2533150.606	38474816.659	J2820	2532822.583	38474252.349	J2883	2532815.963	38473199.113	J2946	2532815.096	38472540.015	J3009	2532502.190	38472251.809
		J2695	2532737.855	38474016.307	J2695	2532776.018	38474396.041	J2758	2533136.668	38474802.315	J2821	2532822.449	38474250.309	J2884	2532815.361	38473178.869	J2947	2532812.099	38472540.151	J3010	2532497.994	38472245.157
		J2696	2532736.938	38474019.327	J2696	2532775.981	38474396.275	J2759	2533123.683	38474788.951	J2822	2532821.736	38474247.411	J2885	2532813.520	38473158.635	J2948	2532802.656	38472541.253	J3011	2532497.683	38472244.413
		J2697	2532736.028	38474022.353	J2697	2532775.838	38474401.963	J2760	2533122.730	38474787.971	J2823	2532821.053	38474244.597	J2886	2532811.440	38473138.413	J2949	2532790.620	38472543.539	J3012	2532494.741	38472235.847
		J2698	2532735.124	38474025.381	J2698	2532775.592	38474412.147	J2761	2533108.814	38474773.637	J2824	2532820.378	38474241.781	J2887	2532809.123	38473118.207	J2950	2532779.479	38472547.983	J3013	2532493.716	38472225.577
		J2699	2532734.221	38474028.437	J2699	2532771.787	38474419.877	J2762	2533094.955	38474759.299	J2825	2532819.711	38474238.963	J2888	2532806.606	38473098.013	J2951	2532769.170	38472553.469	J3014	2532489.564	38472216.447
		J2700	2532733.716	38474030.487	J2700	2532766.968	38474438.541	J2763	2533081.184	38474744.927	J2826	2532819.199	38474236.769	J2889	2532803.404	38473071.079	J2952	2532760.079	38472560.455	J3015	2532488.254	38472206.279
		J2701	2532732.972	38474033.535	J2701	2532789.866	38474441.885	J2764	2533067.533	38474730.493	J2827	2532818.365	38474231.377	J2890	2532802.359	38473065.731	J2953	2532751.829	38472567.955	J3016	2532487.252	38472196.001
		J2702	2532732.236	38474036.585	J2702	2532813.664	38474437.209	J2765	2533054.031	38474715.971	J2828	2532812.590	38474212.827	J2891	2532801.751	38473061.161	J2954	2532743.781	38472575.071	J3017	2532483.578	38472186.697
		J2703	2532731.507	38474039.641	J2703	2532825.446	38474465.419	J2766	2533040.710	38474701.333	J2829	2532817.481	38474192.413	J2892	2532800.470	38473051.287	J2955	2532737.734	38472570.589	J3018	2532482.603	38472182.603
		J2704	2532730.786	38474042.703	J2704	2532833.665	38474484.039	J2767	2533027.602	38474686.555	J2830	2532819.056	38474172.813	J2893	2532799.956	38473041.445	J2956	2532734.680	38472580.391	J3019	2532480.143	38472177.785
		J2705	2532730.072	38474045.767	J2705	2532842.255	38474502.493	J2768	2533014.739	38474671.611	J2831	2532819.686	38474153.507	J2894	2532798.293	38473031.631	J2957	2532726.004	38472586.307	J3020	2532476.988	38472169.109
		J2706	2532729.353	38474048.895	J2706	2532851.212	38474520.771	J2769	2532992.156	38474656.479	J2832	2532819.308	38474134.429	J2895	2532797.530	38473021.839	J2958	2532718.020	38472593.111	J3021	2532476.569	38472167.585
		J2707	2532729.236	38474049.981	J2707	2532860.532	38474538.867	J2770	2532980.820	38474649.885	J2833	2532817.559	38474115.531	J2896	2532797.074	38473012.075	J2959	2532710.168	38472600.067	J3022	2532475.092	38472160.077
		J2708	2532728.912	38474053.061	J2708	2532870.213	38474556.771	J2771	2532989.883	38474641.137	J2834	2532813.539	38474096.777	J2897	2532796.988	38473002.345	J2960	2532702.502	38472607.235	J3023	2532474.503	38472151.807
		J2709	2532728.597	38474056.145	J2709	2532880.250	38474574.481	J2772	2532977.921	38474625.553	J2835	2532815.400	38474077.647	J2898	2532797.000	38473001.531	J2961	2532695.755	38472615.297	J3024	2532474.398	38472150.791
		J2710	2532728.289	38474059.231	J2710	2532890.639	38474591.983	J2773	2532966.273	38474609.735	J2836	2532812.142	38474058.553	J2899	2532797.329	38472992.647	J2962	2532689.479	38472623.219	J3025	2532473.355	38472140.845
		J2711	2532727.990	38474062.321	J2711	2532901.376	38474609.277	J2774	2532954.944	38474593.685	J2837	2532819.928	38474045.231	J2900	2532797.582	38472999.515	J2963	2532682.586	38472631.541	J3026	2532472.210	38472130.911
		J2712	2532727.707	38474065.415	J2712	2532912.457	38474626.351	J2775	2532943.938	38474577.413	J2838	2532818.746	38474039.693	J2901	2532800.583	38472989.735	J2964	2532675.320	38472639.149	J3027	2532470.920	38472120.993
		J2713	2532727.418	38474068.511	J2713	2532923.877	38474643.199	J2776	2532933.260	38474560.925	J2839	2532814.362	38474020.653	J2902	2532803.349	38472983.519	J2965	2532671.709	38472643.467	J3028	2532469.010	38472111.151
		J2714	2532727.146	38474071.611	J2714	2532935.632	38474659.817	J2777	2532922.913	38474544.225	J2840	2532812.462	38474001.421	J2903	2532806.714	38472974.455	J2966	2532668.636	38472647.247	J3029	2532465.524	38472101.499
		J2715	2532726.883	38474074.713	J2715	2532947.716	38474676.197	J2778	2532912.902	38474527.232	J2841	2532811.266	38473982.041	J2904	2532810.394	38472968.007	J2967	2532661.823	38472655.733	J3030	2532462.242	38472091.821
		J2716	2532726.629	38474077.817	J2716	2532960.126	38474692.331	J2779	2532903.232	38474510.223	J2842	2532807.800	38473962.381	J2905	2532811.632	38472965.881	J2968	2532653.162	38472637.945	J3031	2532461.178	38472086.647
		J2717	2532726.384	38474080.925	J2717	2532962.409	38474695.227	J2780	2532893.905	38474492.933	J2843	2532800.268	38473942.265	J2906	2532816.908	38472957.691	J2969	2532644.606	38472619.815	J3032	2532460.882	38472076.709
		J2718	2532726.146	38474084.033	J2718	2532972.845	38474708.207	J2781	2532884.926	38474475.461	J2844	2532801.193	38473922.543	J2907	2532814.248	38472950.407	J2970	2532635.008	38472598.931	J3033	2532459.027	38472067.027
		J2719	2532725.923	38474087.143	J2719	2532985.828	38474723.819	J2782	2532876.299	38474457.811	J2845	2532813.646	38473903.661	J2908	2532830.424	38472943.205	J2971	2532629.038	38472585.699	J3034	2532458.815	38472059.406
		J2720	2532725.706	38474090.253	J2720	2532999.038	38474739.191	J2783	2532868.026	38474439.995	J2846	2532818.775	38473885.773	J2909	2532832.989	38472940.333	J2972	2532628.002	38472583.405	J3035	2532457.118	38472053.003
		J2721	2532725.562	38474092.327	J2721	2533012.438	38474754.347	J2784	2532860.110	38474422.015	J2847	2532807.375	38473874.779	J2910	2532836.573	38472936.307	J2973	2532619.851	38472565.141	J3036	2532456.140	38472048.700
		J2722																				

界址点坐标		点号	坐标		点号	坐标		点号	坐标		点号	坐标		点号	坐标	
			X(m)	Y(m)		X(m)	Y(m)		X(m)	Y(m)		X(m)	Y(m)		X(m)	Y(m)
		J3119	2533648.564	38475419.807	J3182	2534021.922	38475673.951									
		J3120	2533662.404	38475434.244	J3183	2534021.743	38475673.782									
		J3121	2533676.244	38475448.682	J3184	2534009.749	38475669.397									
		J3122	2533690.085	38475463.120	J3185	2534003.984	38475670.691									
J3060	2533610.559	38475289.993	J3123	2533703.925	38475477.558	J3186	2534001.235	38475669.692								
J3061	2533617.434	38475276.394	J3124	2533717.765	38475491.995	J3187	2533999.391	38475668.760								
J3062	2533619.072	38475261.857	J3125	2533720.360	38475494.702	J3188	2533999.398	38475660.814								
J3063	2533619.392	38475261.547	J3126	2533705.423	38475510.642	J3189	2533998.731	38475658.359								
J3064	2533620.758	38475254.811	J3127	2533755.770	38475562.174	J3190	2533995.538	38475648.428								
J3065	2533621.212	38475252.569	J3128	2533770.633	38475547.146											
J3066	2533619.234	38475249.721	J3129	2533773.126	38475549.746											
J3067	2533617.500	38475247.223	J3130	2533786.967	38475564.184											
J3068	2533615.362	38475244.144	J3131	2533800.807	38475578.621											
J3069	2533612.296	38475239.730	J3132	2533814.647	38475593.058											
J3070	2533610.562	38475237.232	J3133	2533828.488	38475607.496											
J3071	2533609.011	38475234.999	J3134	2533842.328	38475621.934											
J3072	2533602.537	38475236.624	J3135	2533856.168	38475636.372											
J3073	2533596.733	38475238.081	J3136	2533870.008	38475650.809											
J3074	2533588.990	38475240.024	J3137	2533878.407	38475659.570											
J3075	2533583.298	38475241.453	J3138	2533871.936	38475670.161											
J3076	2533579.322	38475242.450	J3139	2533871.166	38475683.638											
J3077	2533573.417	38475243.932	J3140	2533871.118	38475684.255											
J3078	2533572.924	38475243.014	J3141	2533866.162	38475689.007											
J3079	2533570.414	38475240.989	J3142	2533870.403	38475693.426											
J3080	2533568.062	38475239.092	J3143	2533875.864	38475699.116											
J3081	2533565.710	38475237.195	J3144	2533883.461	38475707.033											
J3082	2533563.357	38475235.297	J3145	2533890.678	38475714.552											
J3083	2533561.005	38475233.400	J3146	2533895.736	38475719.823											
J3084	2533558.073	38475231.035	J3147	2533900.398	38475724.680											
J3085	2533557.211	38475230.340	J3148	2533904.928	38475729.401											
J3086	2533553.321	38475224.262	J3149	2533905.471	38475729.584											
J3087	2533552.347	38475222.740	J3150	2533909.198	38475730.166											
J3088	2533550.696	38475220.161	J3151	2533912.926	38475730.749											
J3089	2533549.045	38475217.583	J3152	2533916.653	38475731.332											
J3090	2533547.395	38475215.004	J3153	2533918.144	38475731.565											
J3091	2533550.135	38475212.299	J3154	2533921.872	38475732.147											
J3092	2533546.754	38475205.350	J3155	2533925.599	38475732.730											
J3093	2533542.918	38475199.453	J3156	2533929.264	38475733.302											
J3094	2533535.293	38475196.620	J3157	2533930.694	38475733.716											
J3095	2533528.907	38475198.755	J3158	2533934.753	38475734.891											
J3096	2533516.742	38475207.947	J3159	2533936.418	38475735.372											
J3097	2533506.171	38475219.354	J3160	2533947.837	38475742.434											
J3098	2533502.984	38475230.143	J3161	2533945.878	38475743.528											
J3099	2533503.122	38475233.173	J3162	2533944.682	38475748.192											
J3100	2533492.736	38475245.169	J3163	2533955.740	38475764.096											
J3101	2533504.233	38475277.022	J3164	2533964.179	38475763.997											
J3102	2533527.942	38475281.755	J3165	2533982.197	38475752.843											
J3103	2533527.360	38475295.229	J3166	2533992.036	38475752.455											
J3104	2533516.870	38475307.159	J3167	2533993.890	38475754.389											
J3105	2533511.826	38475314.771	J3168	2533995.994	38475752.298											
J3106	2533510.320	38475321.478	J3169	2534004.709	38475751.954											
J3107	2533511.595	38475326.629	J3170	2534017.710	38475747.310											
J3108	2533513.564	38475330.914	J3171	2534018.316	38475746.720											
J3109	2533523.616	38475339.365	J3172	2534022.824	38475746.174											
J3110	2533529.410	38475344.201	J3173	2534040.704	38475728.123											
J3111	2533550.752	38475347.340	J3174	2534041.559	38475721.277											
J3112	2533570.635	38475349.058	J3175	2534040.665	38475718.889											
J3113	2533574.813	38475350.251	J3176	2534041.981	38475715.138											
J3114	2533579.362	38475347.618	J3177	2534034.824	38475703.377											
J3115	2533593.203	38475362.056	J3178	2534024.140	38475698.048											
J3116	2533607.043	38475376.493	J3179	2534021.214	38475700.025											
J3117	2533620.883	38475390.931	J3180	2534018.703	38475697.826											
J3118	2533634.724	38475405.369	J3181	2534016.887	38475696.235											

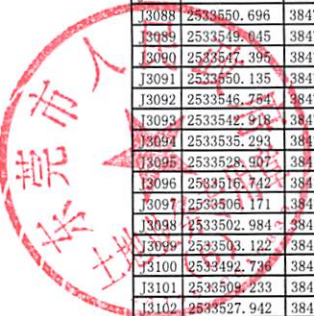

东莞至番禺高速公路桥头至沙田段项目(厚街镇)界址点成果表8-8

红线面积: 80.5170公顷

2000国家大地坐标系(政务版)

东莞市测绘院

二〇二〇年四月